

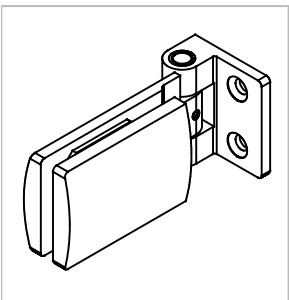

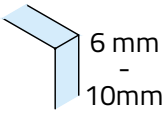

Technische Daten:
Glastürscharnier - Helena

Datasheet:
Glass door hinge - Helena

Art. 41.0501.000.10
Art. 41.0501.000.12
Art. 41.0501.000.26

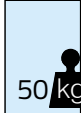
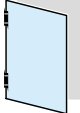

| | | | | |
|--------------------------------|---|--|---|---|
| Ausführung: Options: |  6 mm - 10mm |  1200 mm max. |  50 kg max. |  DIN links/left +  DIN rechts/right |
| | Material: Material: | V2A Stainless steel AISI 304 | | Gewicht: / Weight: 0,476 kg |
| Oberflächen: Finish: | Edelstahl-Design Stainless steel design | Chrom-Design Chrome design | Anthrazit-Design Anthracite design | |

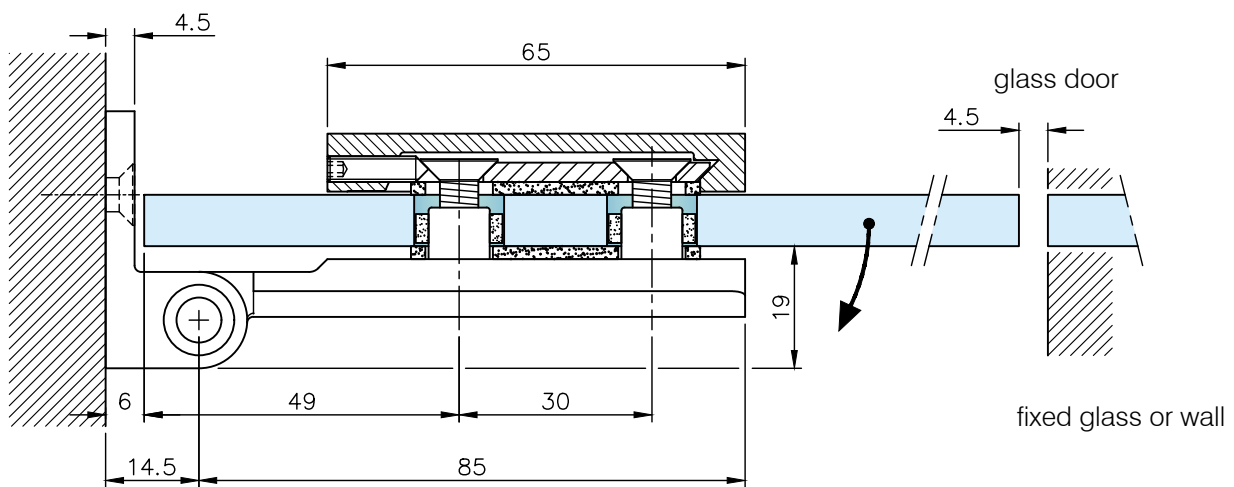
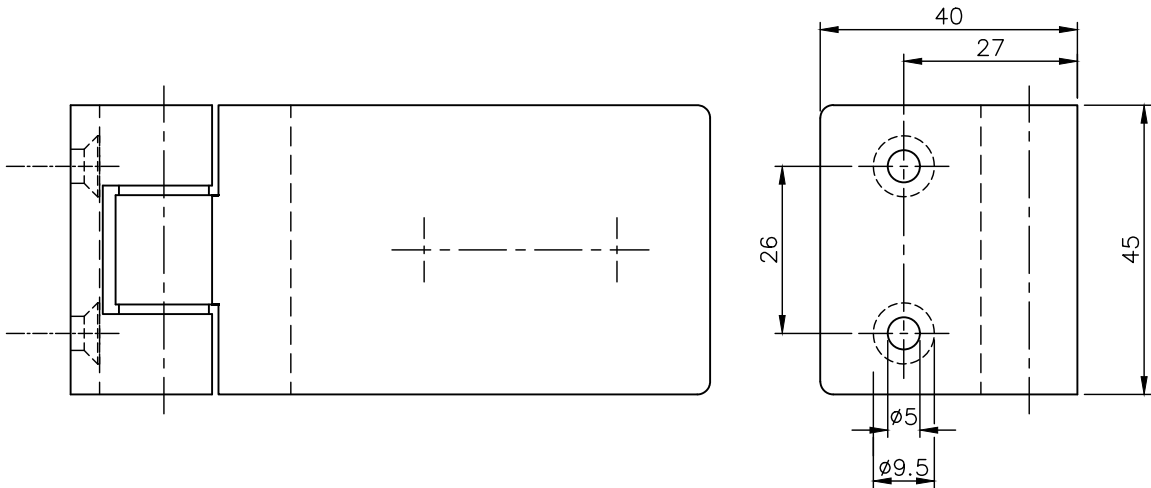

*drawing shows
8mm glass

G-FITTINGS GmbH

Marie-Curie-Straße 16-18
46446 Emmerich am Rhein
T +49 (0)2822 962 0
F +49 (0)2822 962 221
E sales@g-fittings.com

Art. 41.0501.000.10
 Art. 41.0501.000.12
 Art. 41.0501.000.26

Glasbearbeitung:
 Glass preparation:

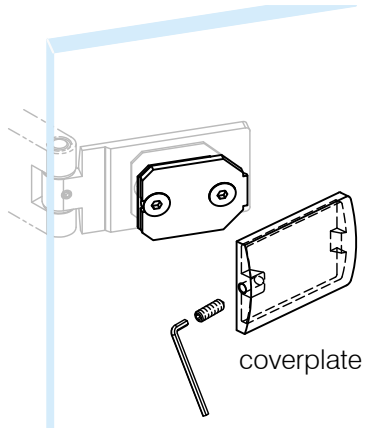
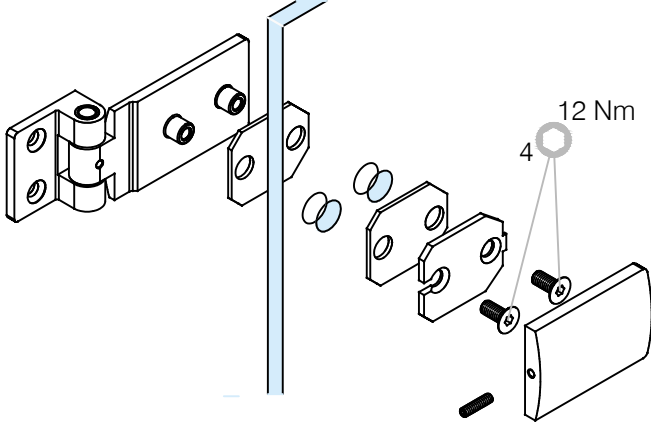
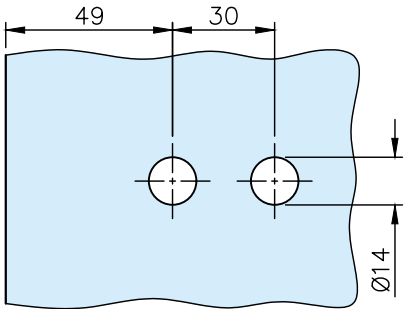

G-FITTINGS GmbH
 Marie-Curie-Straße 16-18
 46446 Emmerich am Rhein
 T +49 (0)2822 962 0
 F +49 (0)2822 962 221
 E sales@g-fittings.com

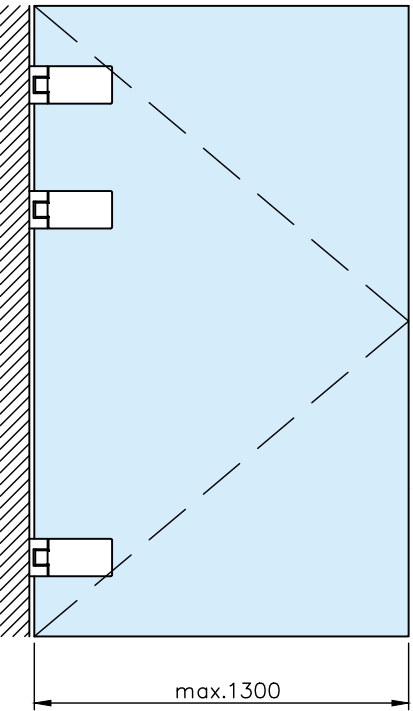
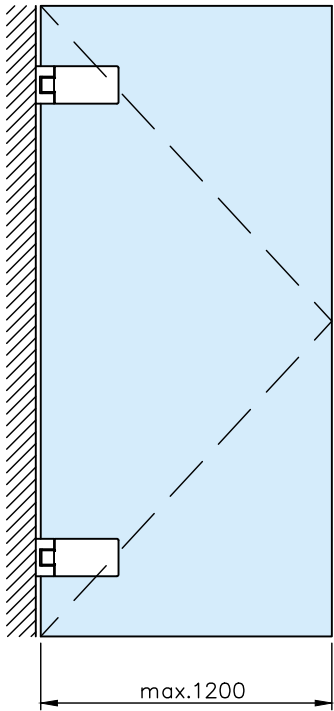

(no scaled view)

Art. 41.0501.000.10
 Art. 41.0501.000.12
 Art. 41.0501.000.26

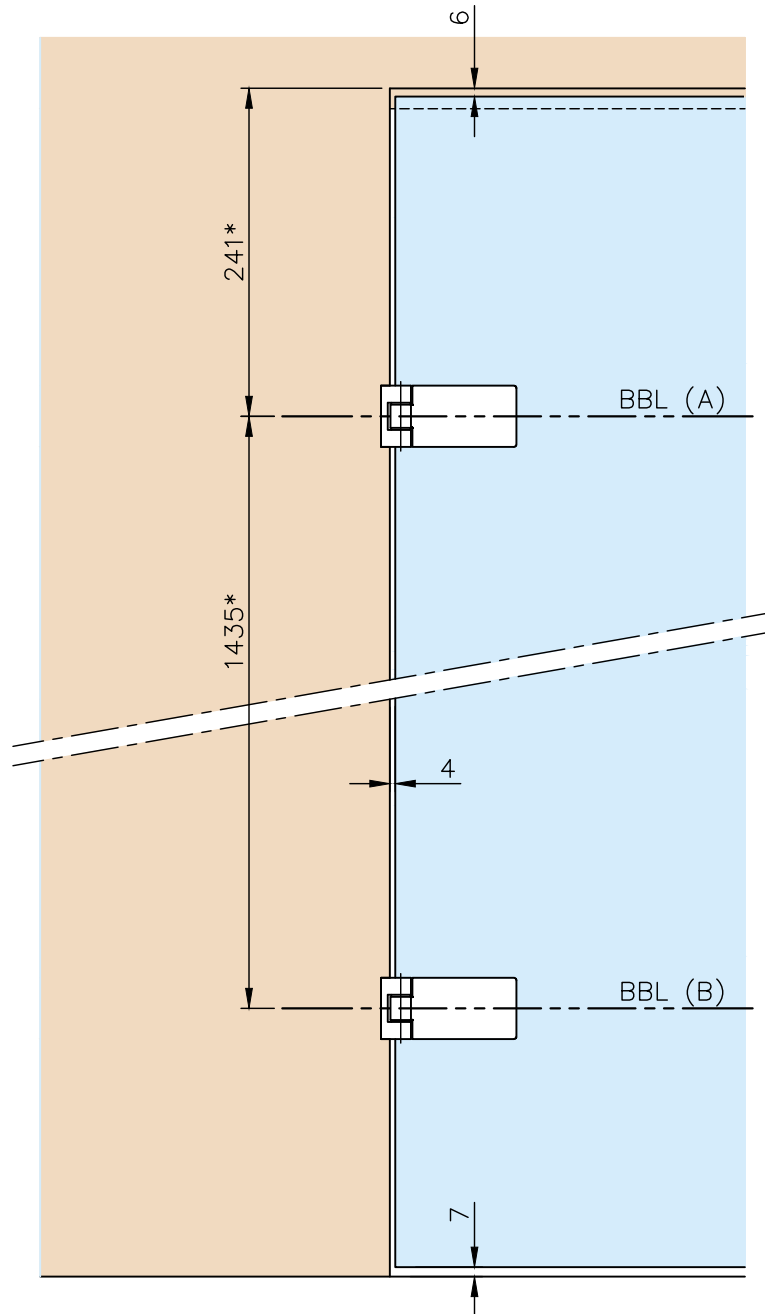

(no scaled view)

Empfehlungsmaße entsprechend *DIN 18268
 Recommended dimensions according to *DIN 18268

| <i>Glastürhöhe</i> Glass door height | <i>Abstand Zargenfalz - BBL(A)</i> distance frame rebate - BBL(A) | <i>Abstand BBL(A) - BBL(B)</i> distance BBL(A) - BBL(B) |
|---|---|---|
| 1860 mm - 2110 mm | 241 +1 mm | 1435 mm ±0,5 mm |
| 2111 mm - 2235 mm | 241 +1 mm | 1560 mm ±0,5 mm |
| 2236 mm - 2360 mm | 241 +1 mm | 1685 mm ±0,5 mm |

G-FITTINGS GmbH

Marie-Curie-Straße 16-18
 46446 Emmerich am Rhein
 T +49 (0)2822 962 0
 F +49 (0)2822 962 221
 E sales@g-fittings.com