

Technische Daten:
hydraulisches Glastürschrnier - AZRA

Datasheet:
hydraulic glass door hinge - AZRA

Art. 77414612090-12
Art. 77414612090-26

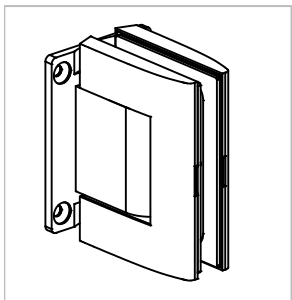

Ausführung: 8 mm - 12mm 1000 mm max. 100 kg max. DIN links/left + DIN rechts/right

Material: V2A **Gewicht: / Weight:** 2,2 kg
Material: Stainless steel AISI 304

Oberflächen: Edelstahl-Design Anthrazit-Design
Finish: Stainless steel design Anthracite design

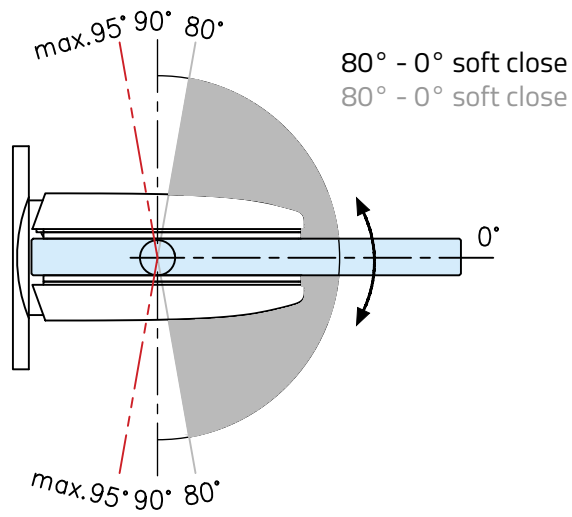
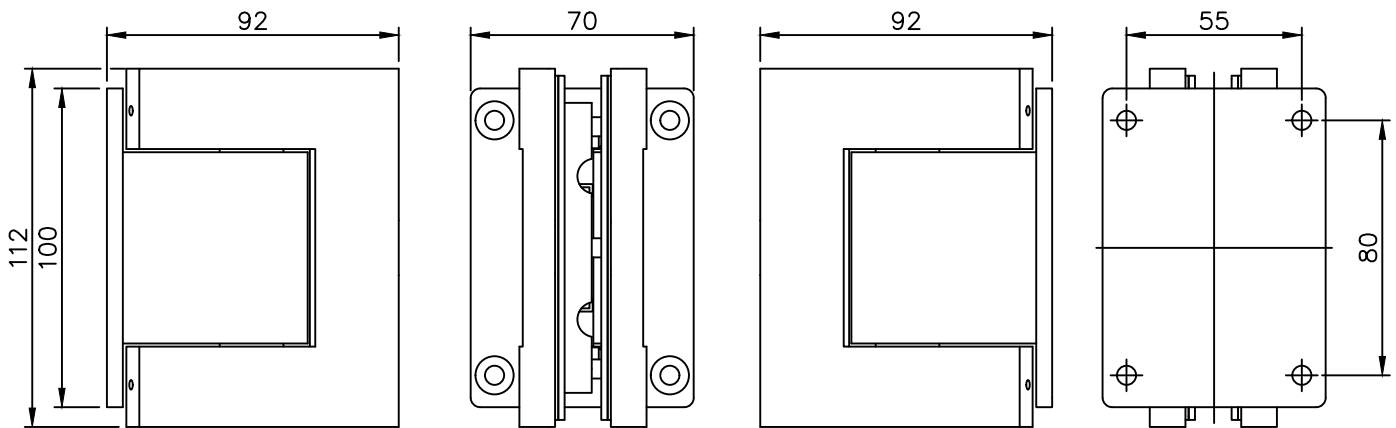

| Gummieinlage Rubberinlay | Glasdicke Glass thickness |
|-----------------------------|------------------------------|
| 1 mm | 12 mm |
| 2 mm | 10 mm |
| 1 mm + 2 mm | 8 mm |

85° - 90° Feststellung:
85° - 90° Hold-open function

Glasbearbeitung:
 Glass preparation:

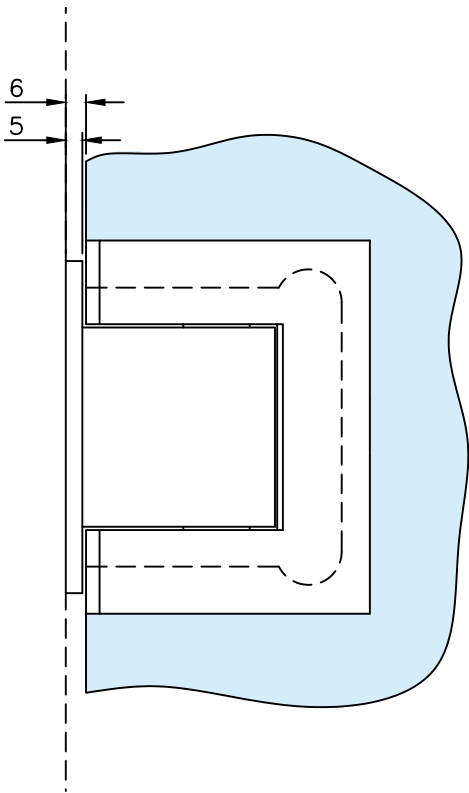
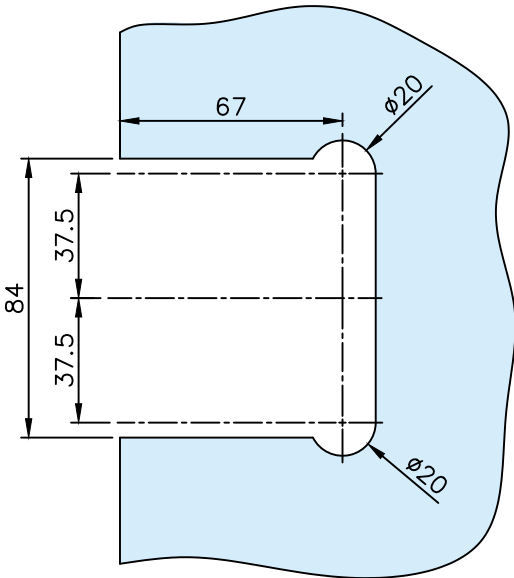

Zusammenbau:
 Assembly:

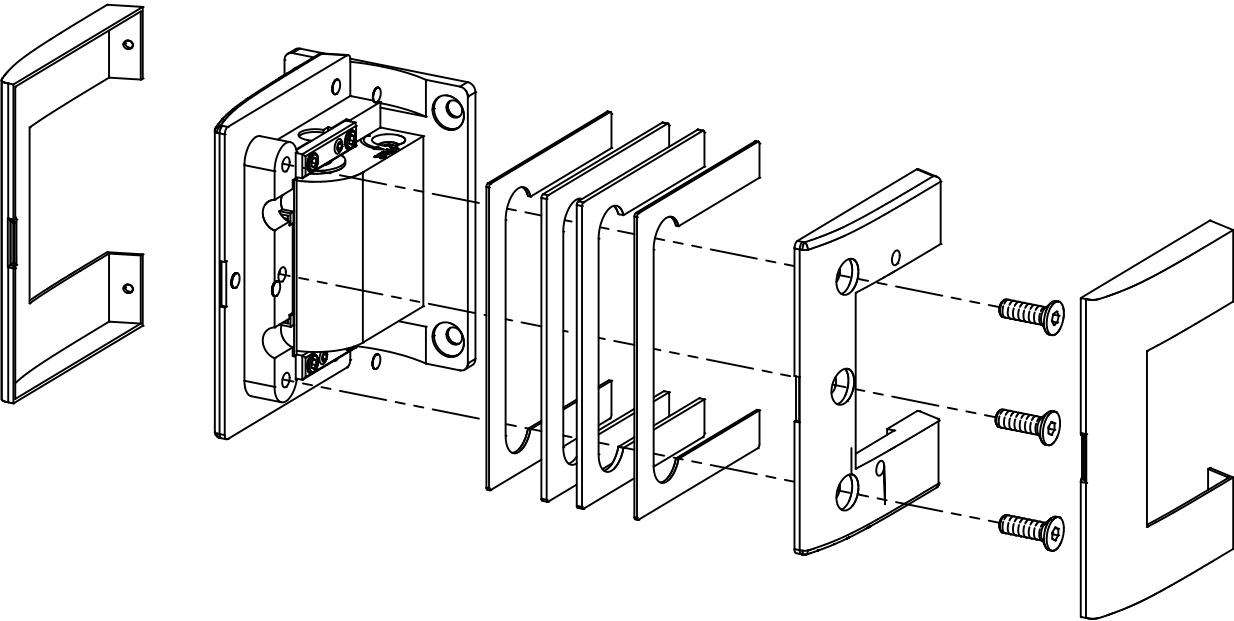

Art. 77414612090-12
Art. 77414612090-26

Montage der Scharniere:
Mounting the hinges:

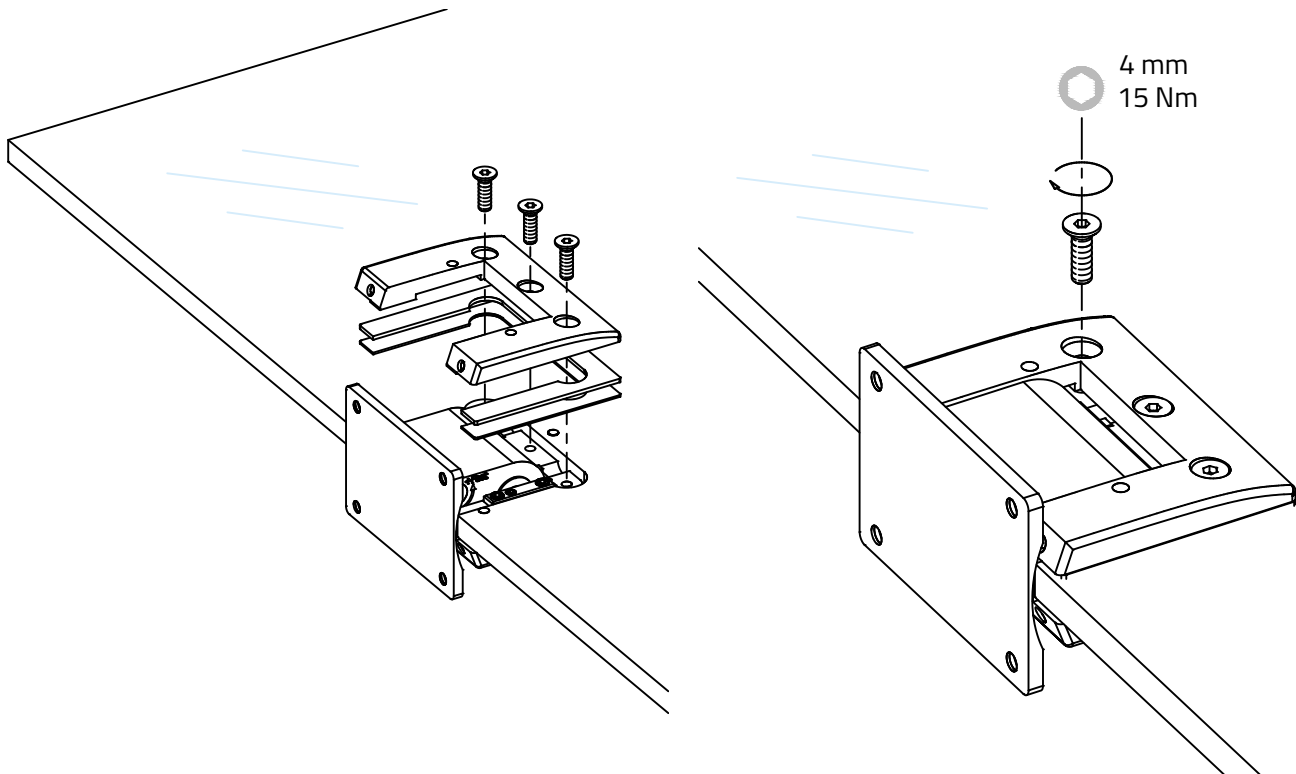
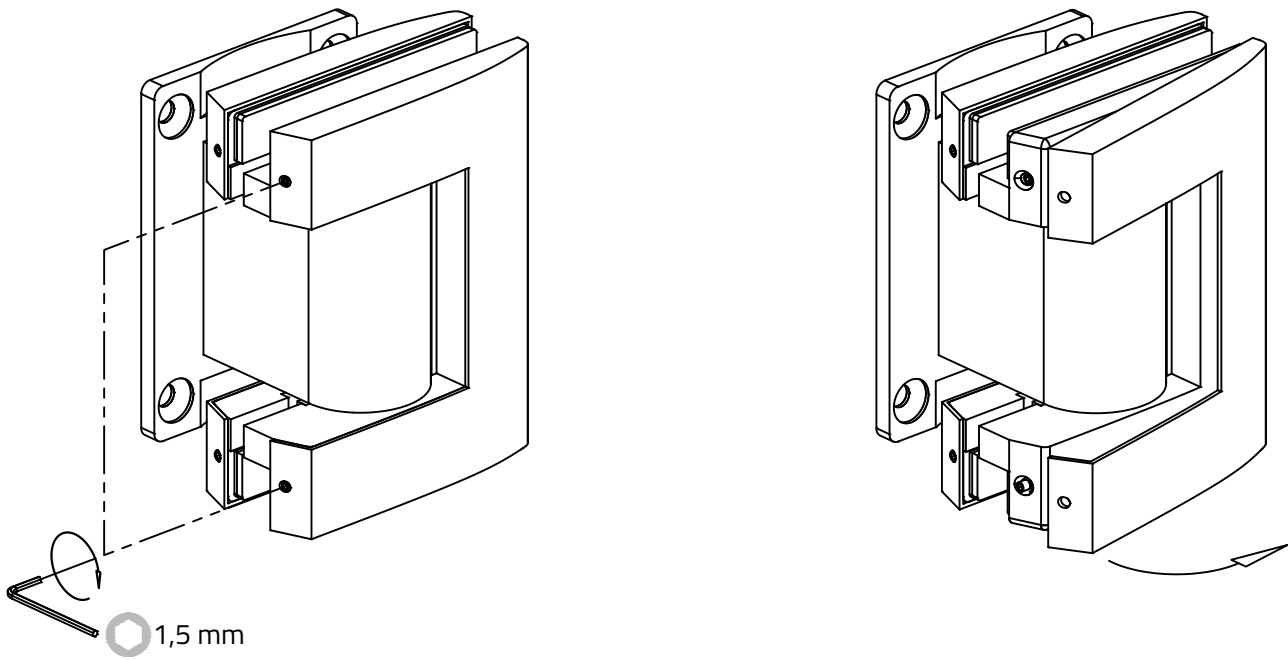

Art. 77414612090-12
Art. 77414612090-26

Einstellen der 0° Stellung der Türe:
Setting the 0° position of the door:

Draufsicht
Top view

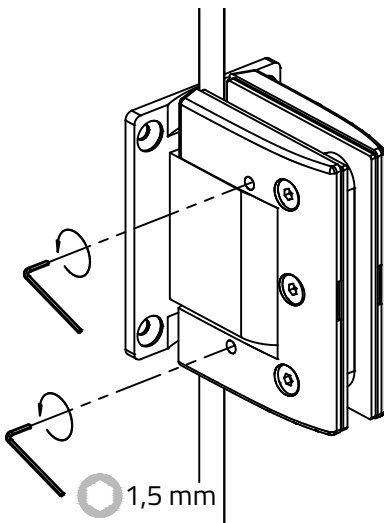
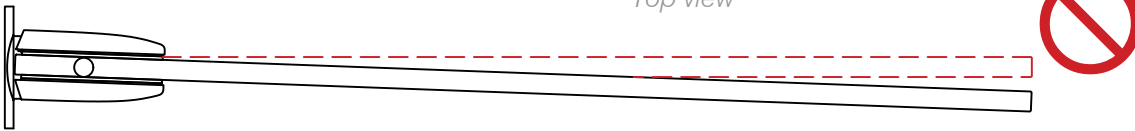

! *Schrauben lösen.*
An beiden Scharnieren.
Loosen the screws.
On both hinges.

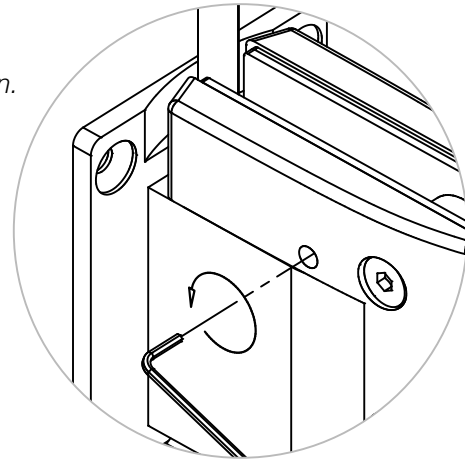

Draufsicht
Top view

! *Ausrichten*
Adjust

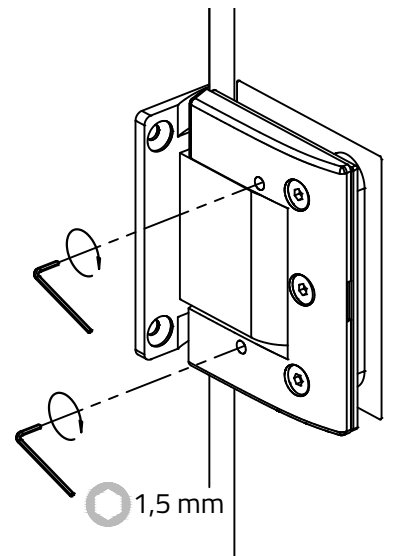

! *Schrauben anziehen.*
An beiden Scharnieren.
Tighten the screws.
On both hinges.

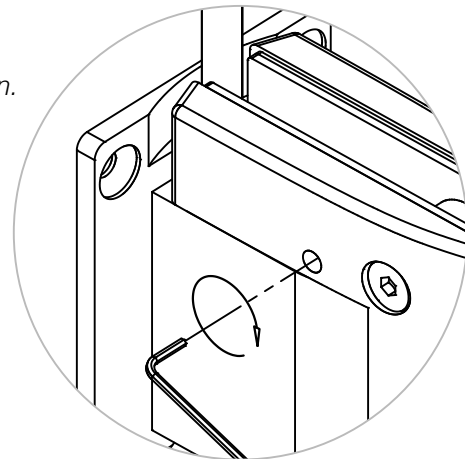

Art. 77414612090-12
Art. 77414612090-26

Einstellen der Türgeschwindigkeit:
Door speed setting:

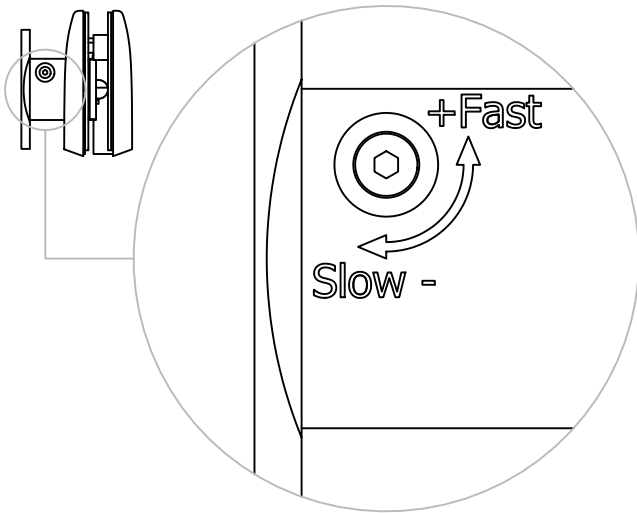

1. Öffnen Sie die Türe auf 90°
1. Open the door to 90°

2. Drehen Sie die Einstellschraube komplett ein (- Slow):
2. turn the adjusting screw fully in (- Slow):

3. Drehen Sie die Einstellschraube eine Viertelumdrehung aus (+ Fast) und prüfen Sie die Schließgeschwindigkeit bei dem schließen der Tür.
3. Turn the adjustment screw a quarter of a turn (+ Fast) and check the closing speed when closing the door.

3. Turn the adjustment screw a quarter of a turn (+ Fast) and check the closing speed when closing the door.

4. Wiederholen Sie Schritt 3 bis das gewünschte Ergebnis erreicht ist.
4. Repeat step 3 until the desired result is achieved.

4. Repeat step 3 until the desired result is achieved.

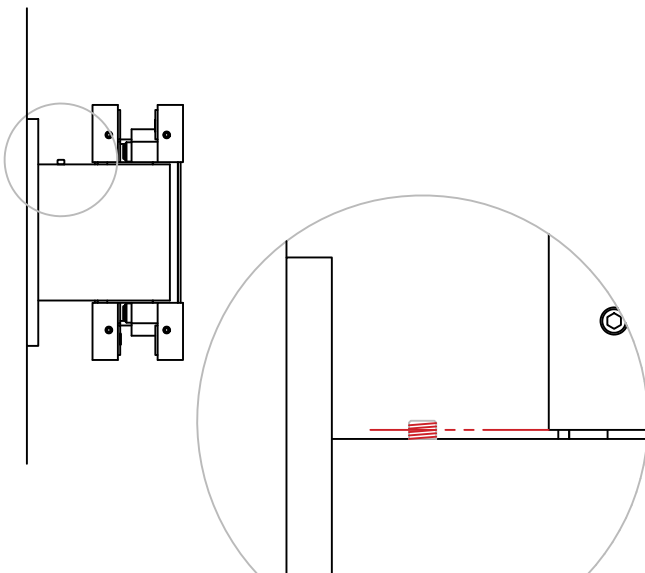

! Drehen Sie die Türstellschraube nicht über die Blockoberfläche hinaus! Kollisionsgefahr!
Do not turn out the speed set screw over the block surface! Danger of collision!

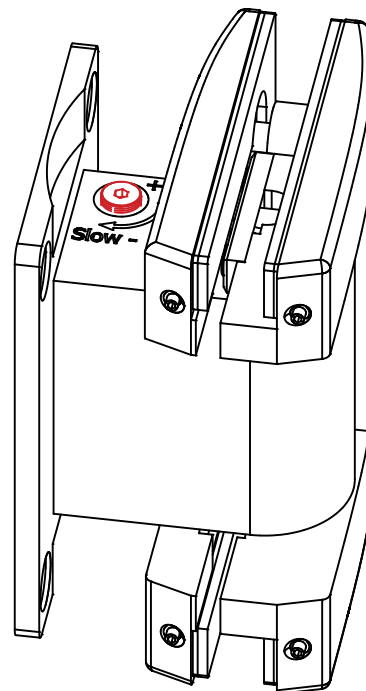

Art. 77414612090-12
Art. 77414612090-26

Abdeckung montieren:
Mount the cover:

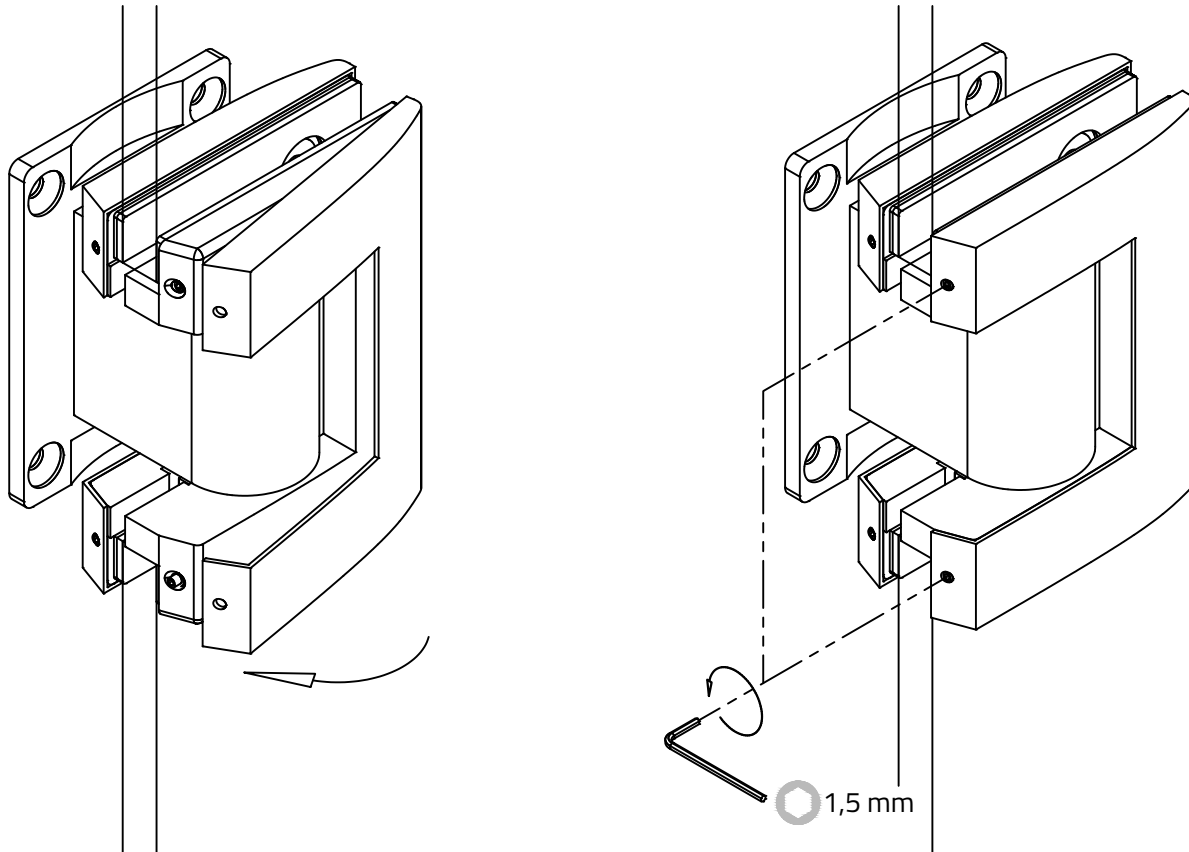

G-FITTINGS GmbH

Marie-Curie-Straße 16-18
46446 Emmerich am Rhein
T +49 (0)2822 962 0
F +49 (0)2822 962 221
E sales@g-fittings.com