

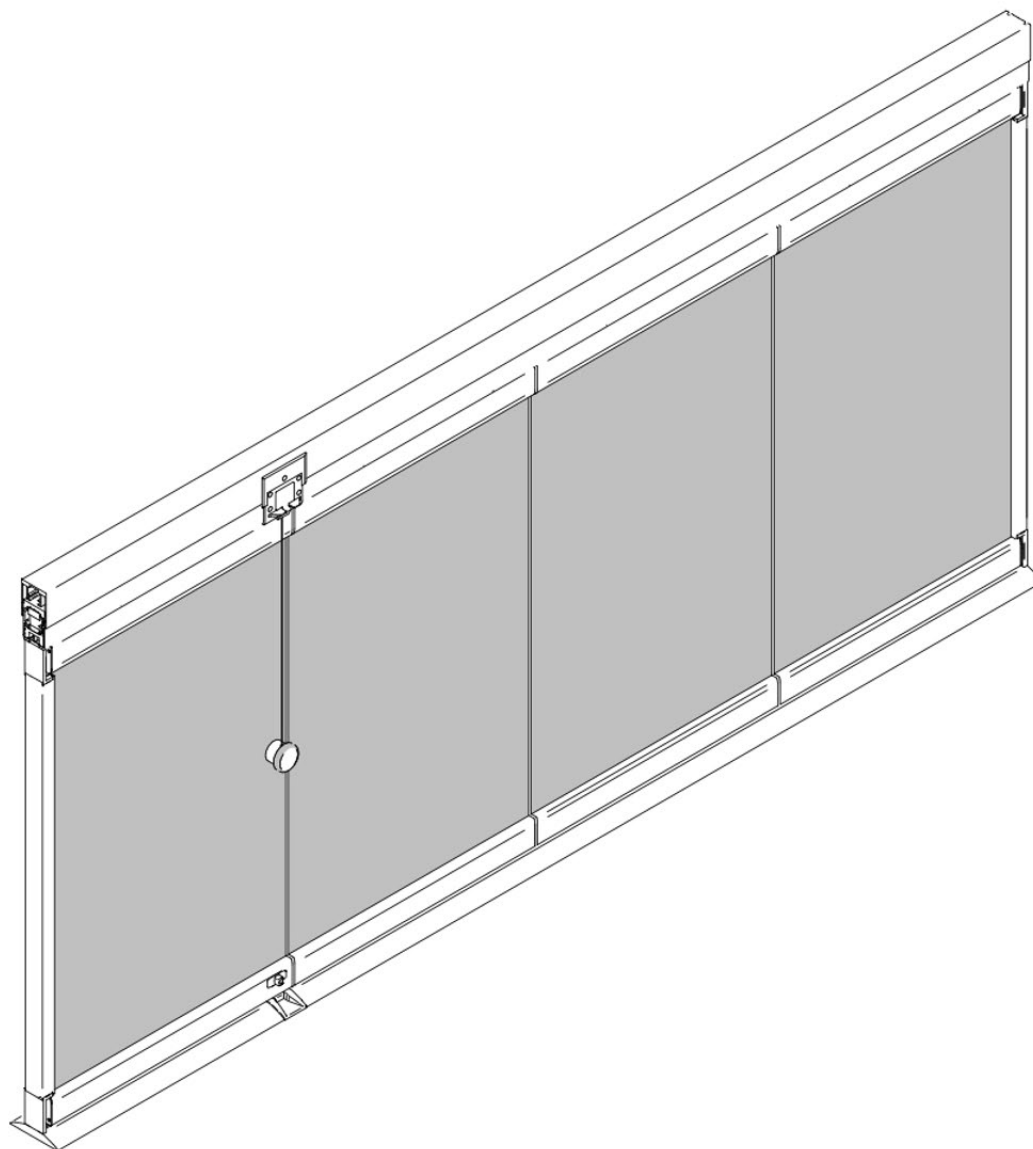

FITTINGS®

Model 3400 - Floor guide



ASSEMBLY INSTRUCTIONS



MAX
50 KG



MAX 800



MAX 3000



8
8+8



8 mm
10 mm



8,76 mm
10,76 mm



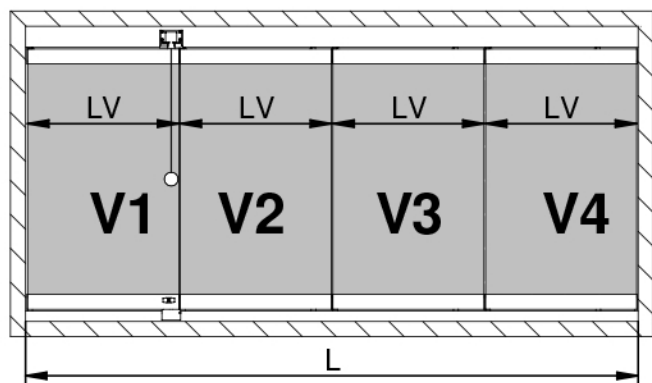
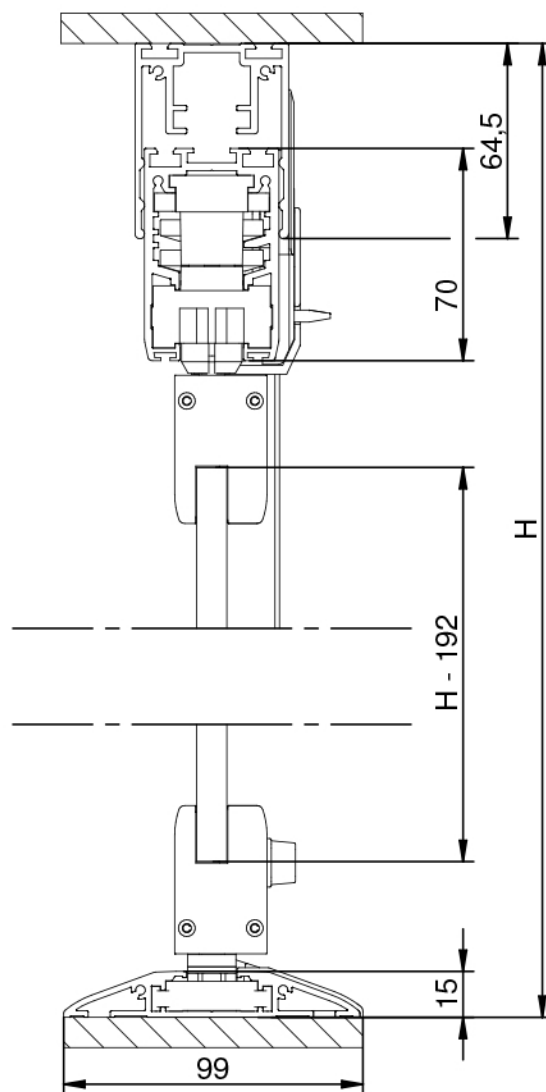

$$LV = \frac{L - 20 - (N \times 5)}{N}$$

Optional:

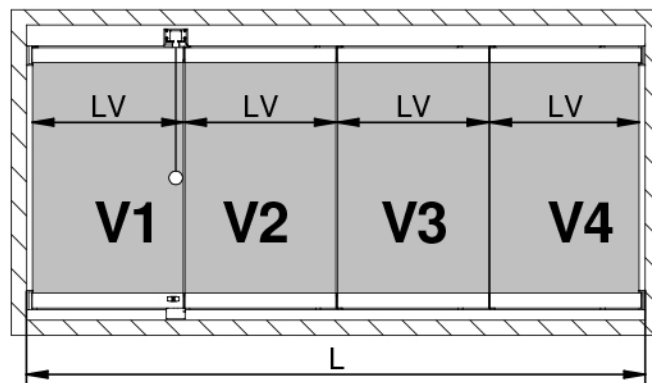

$$LV = \frac{L - 28 (N \times 5)}{N}$$

Swing door

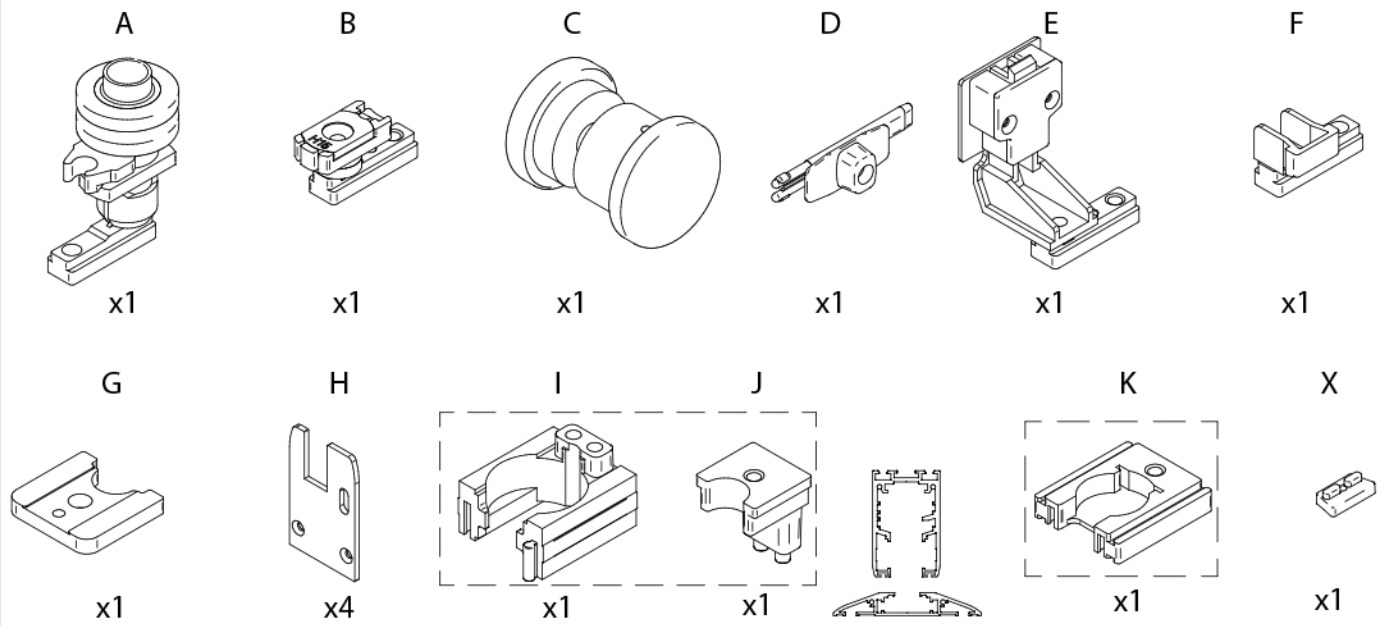

Sliding door

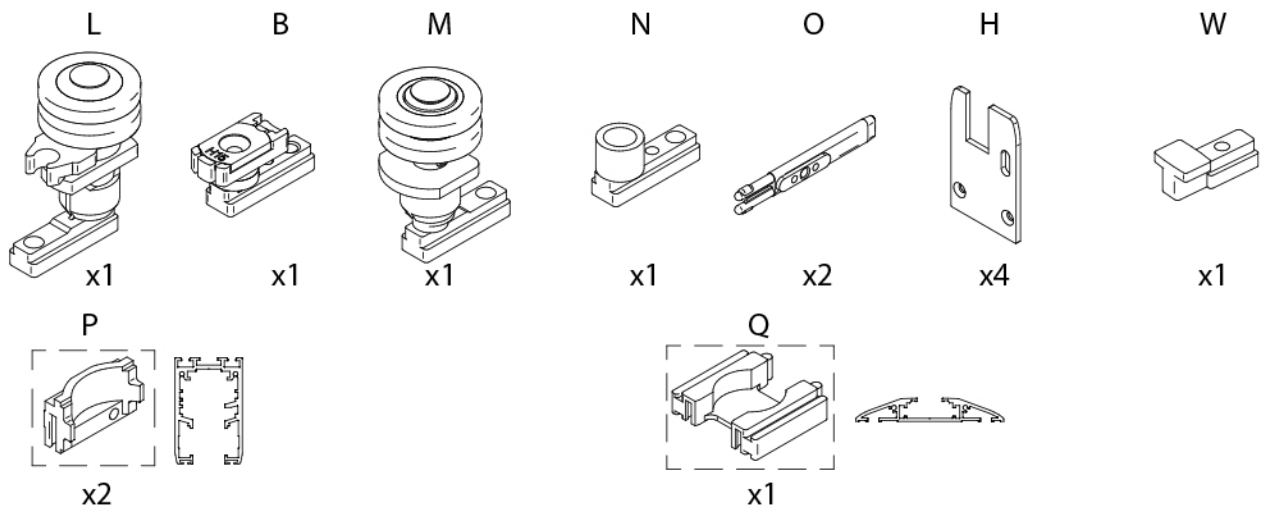

Profiles and parts

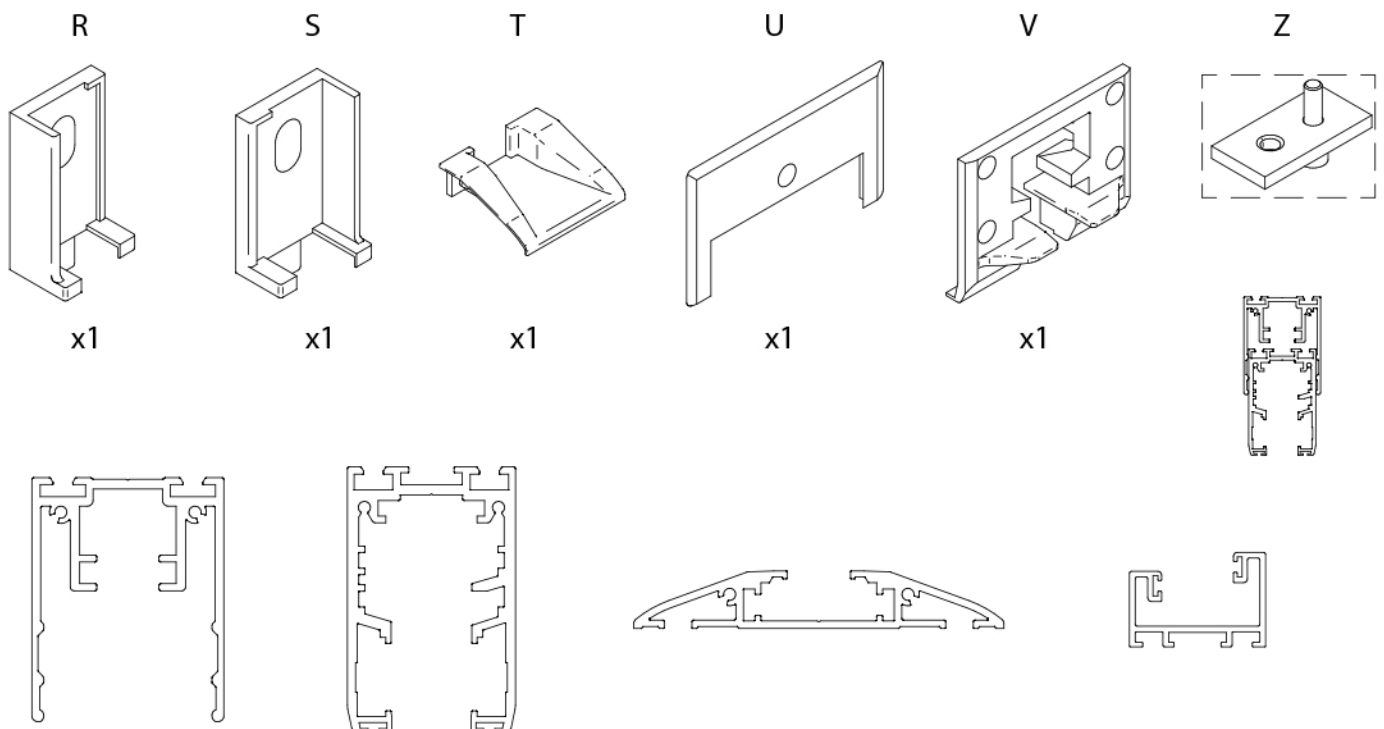

1 Glass clamp mounting

Place the glass clamp aligned with the glass.
Insert the rod and mount the screw with 13 Nm.

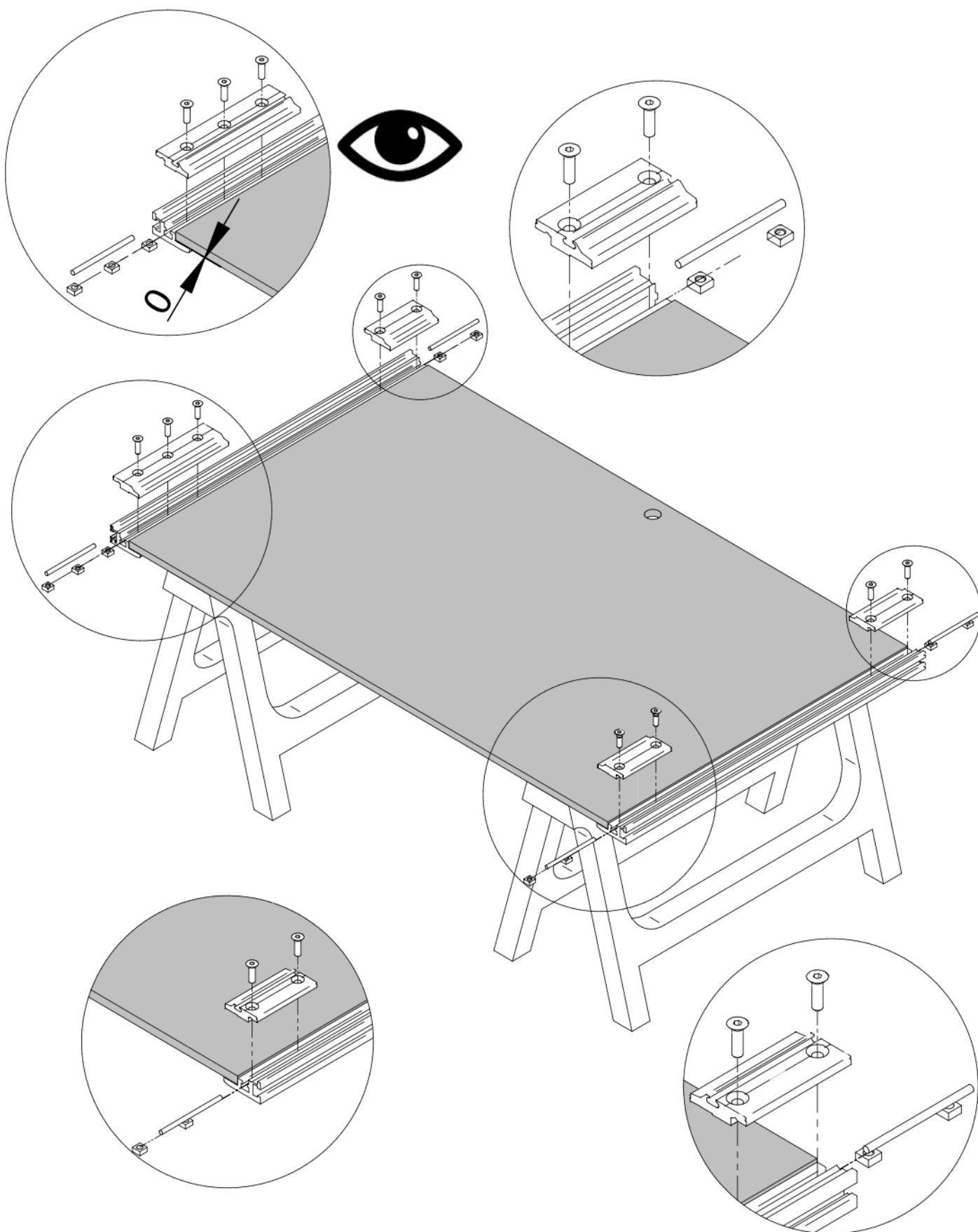

2 Swing door assembly

Mount the cover caps

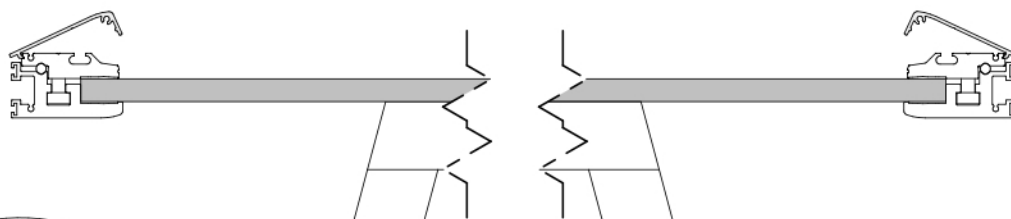

Insert the upper carriages and lock pin

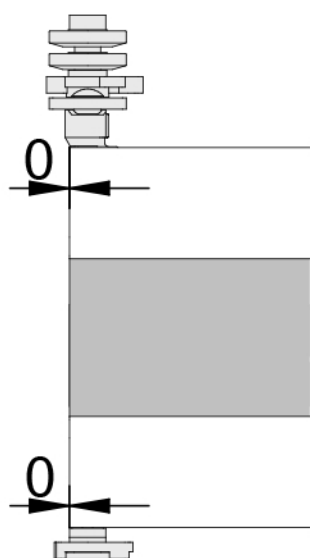
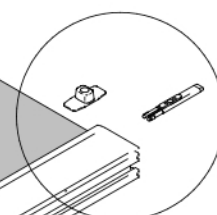
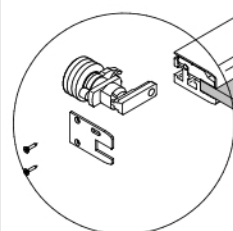
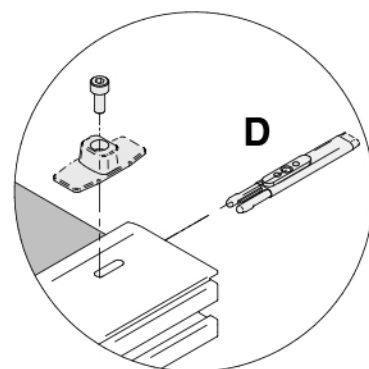
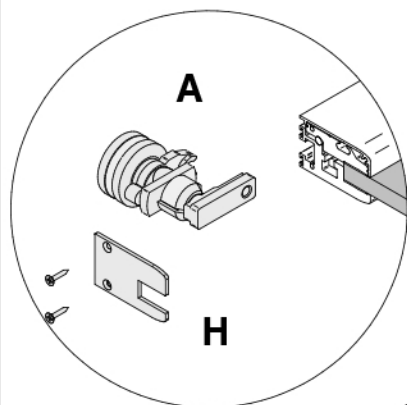

Position
glass clamp
and cover cap

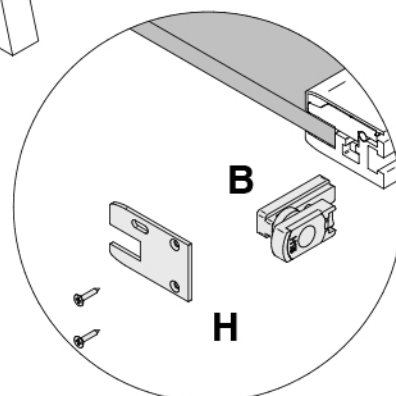

3 Sliding door assembly

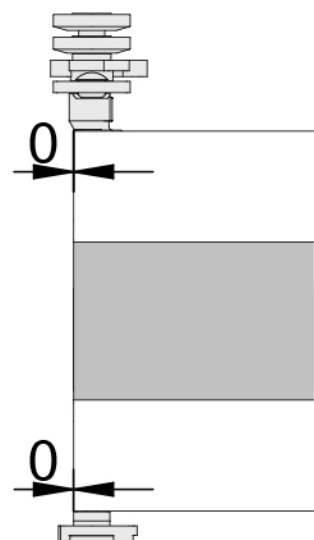
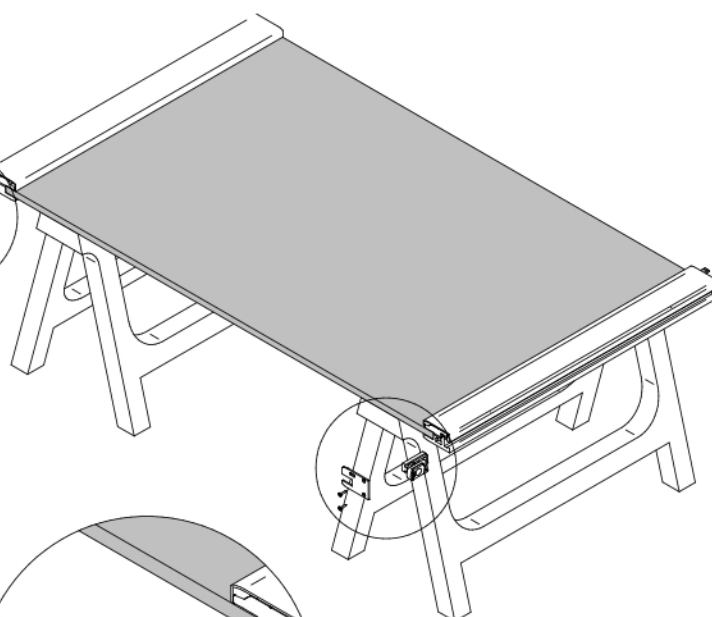
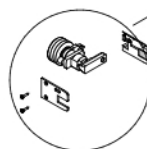
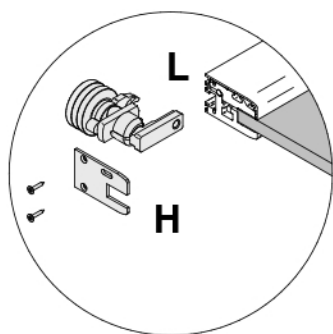
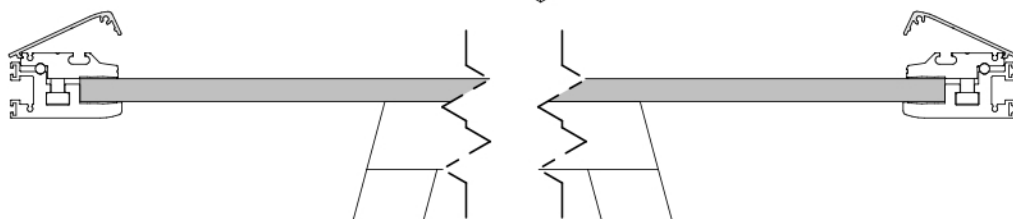
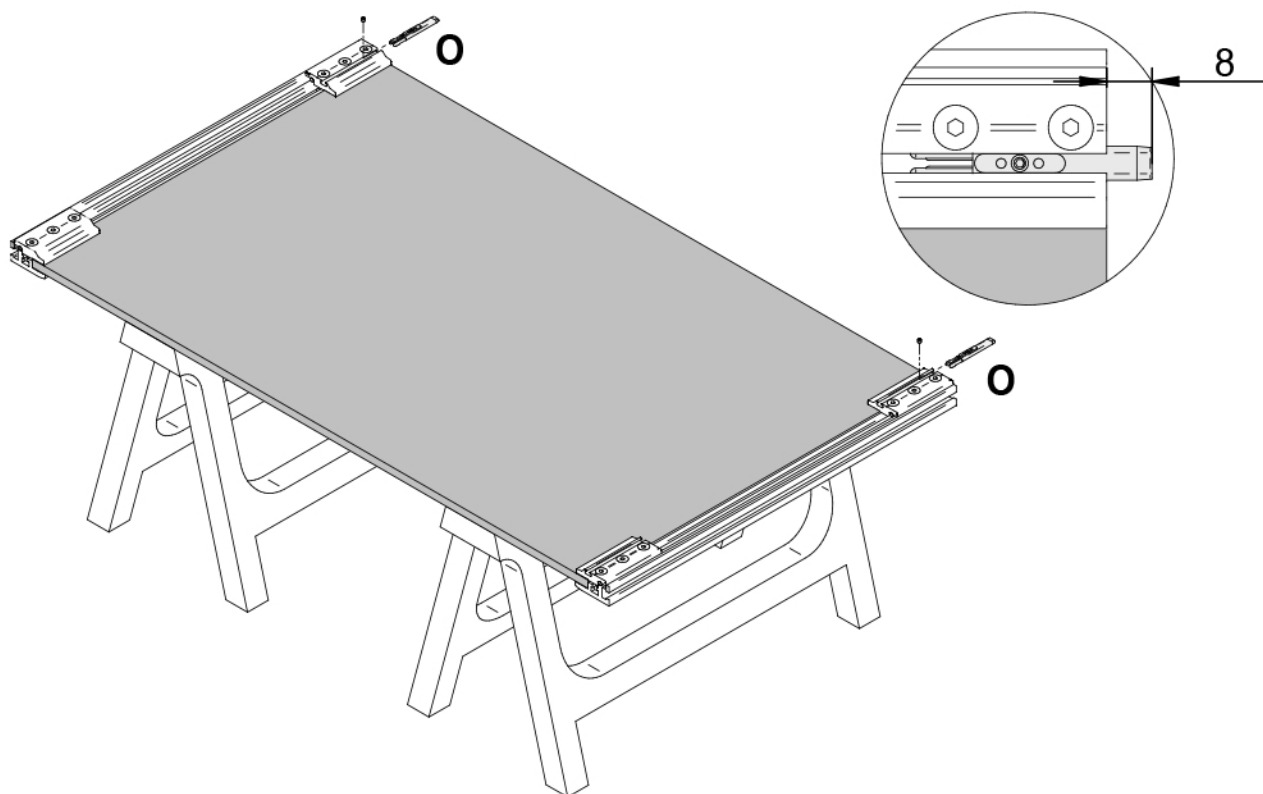

**Position
glass clamp
and cover cap**

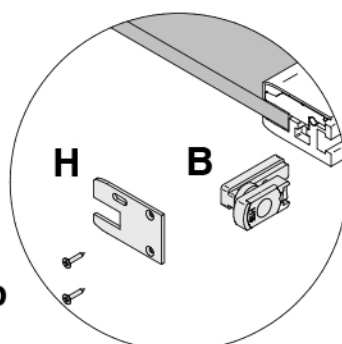

4 Compensator fixing

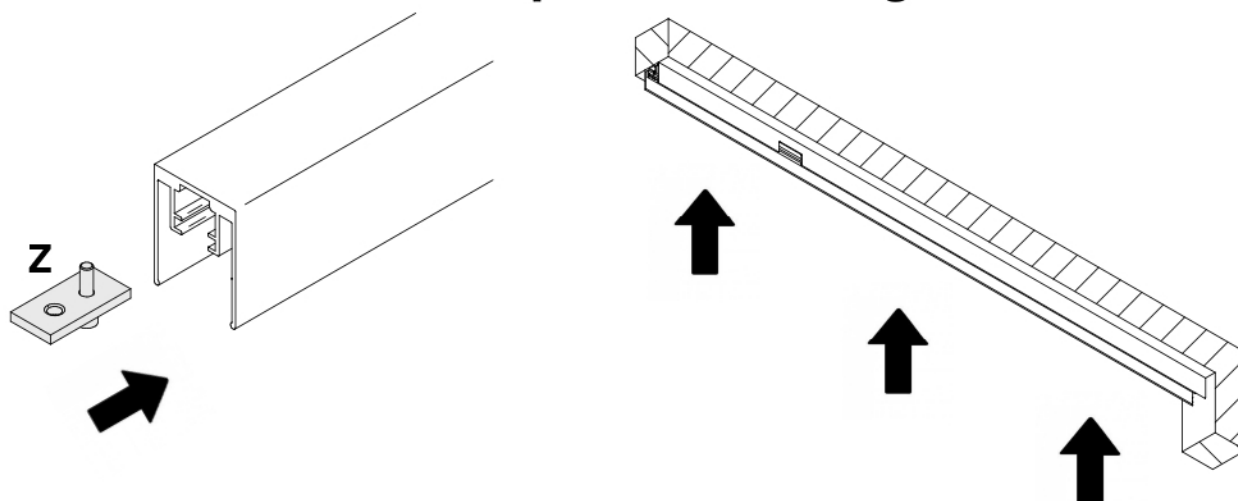

5 Inserting of upper track components

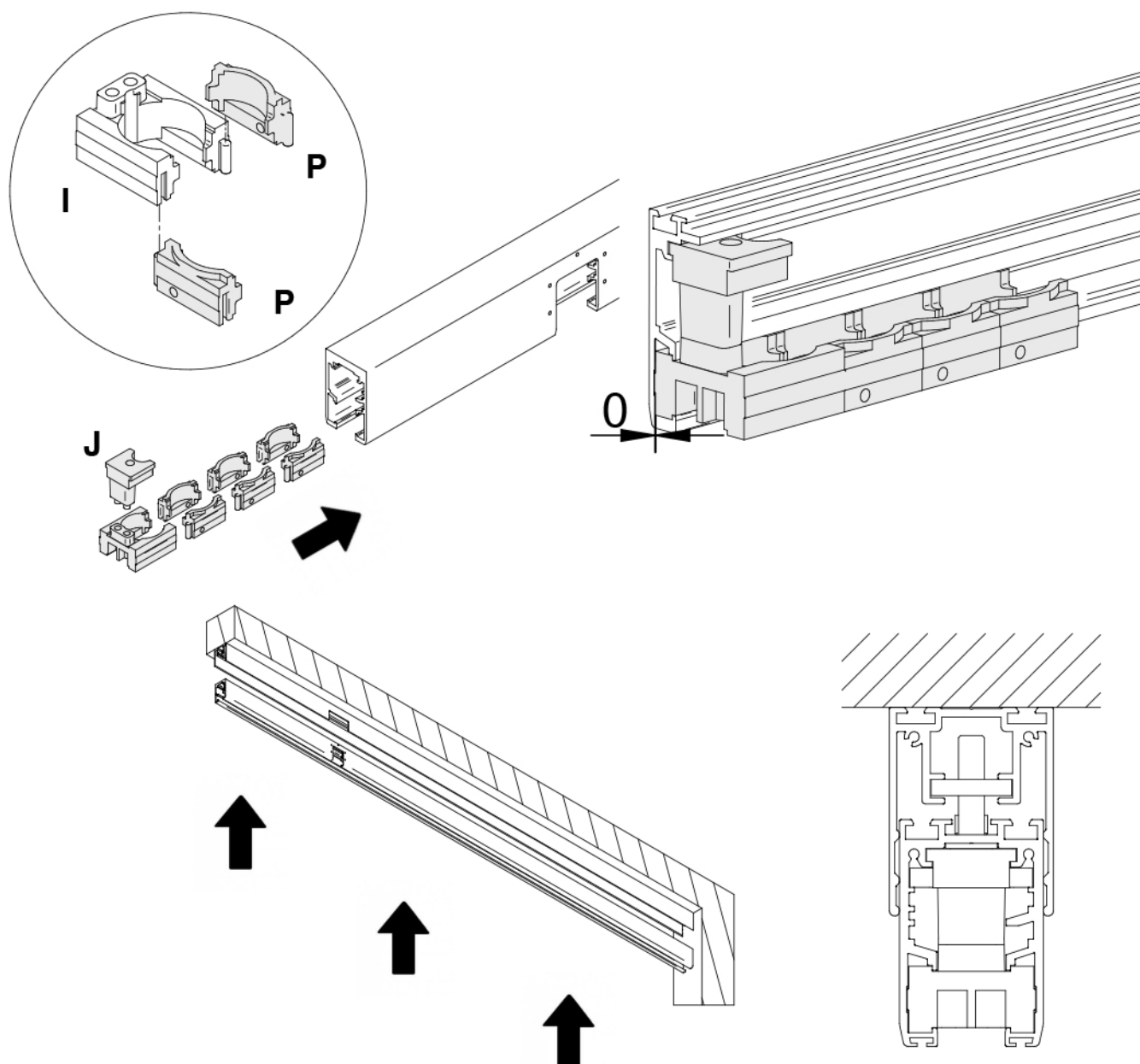

6 Lower track installation

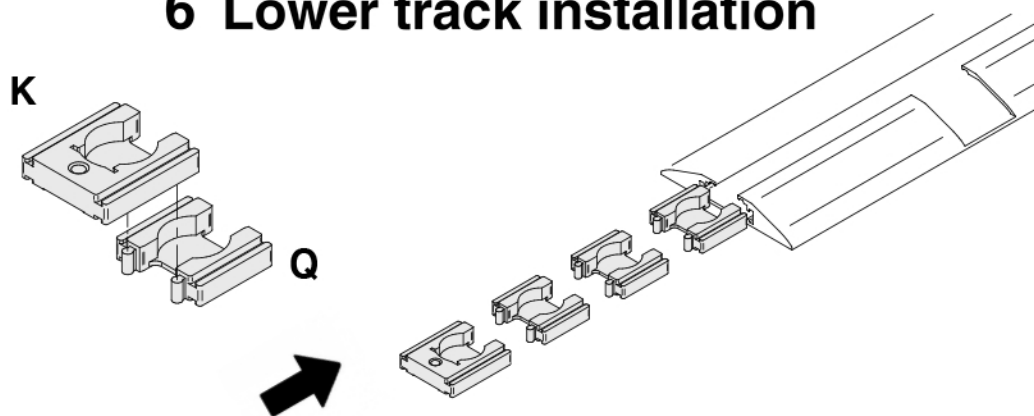

7 Track adjustment

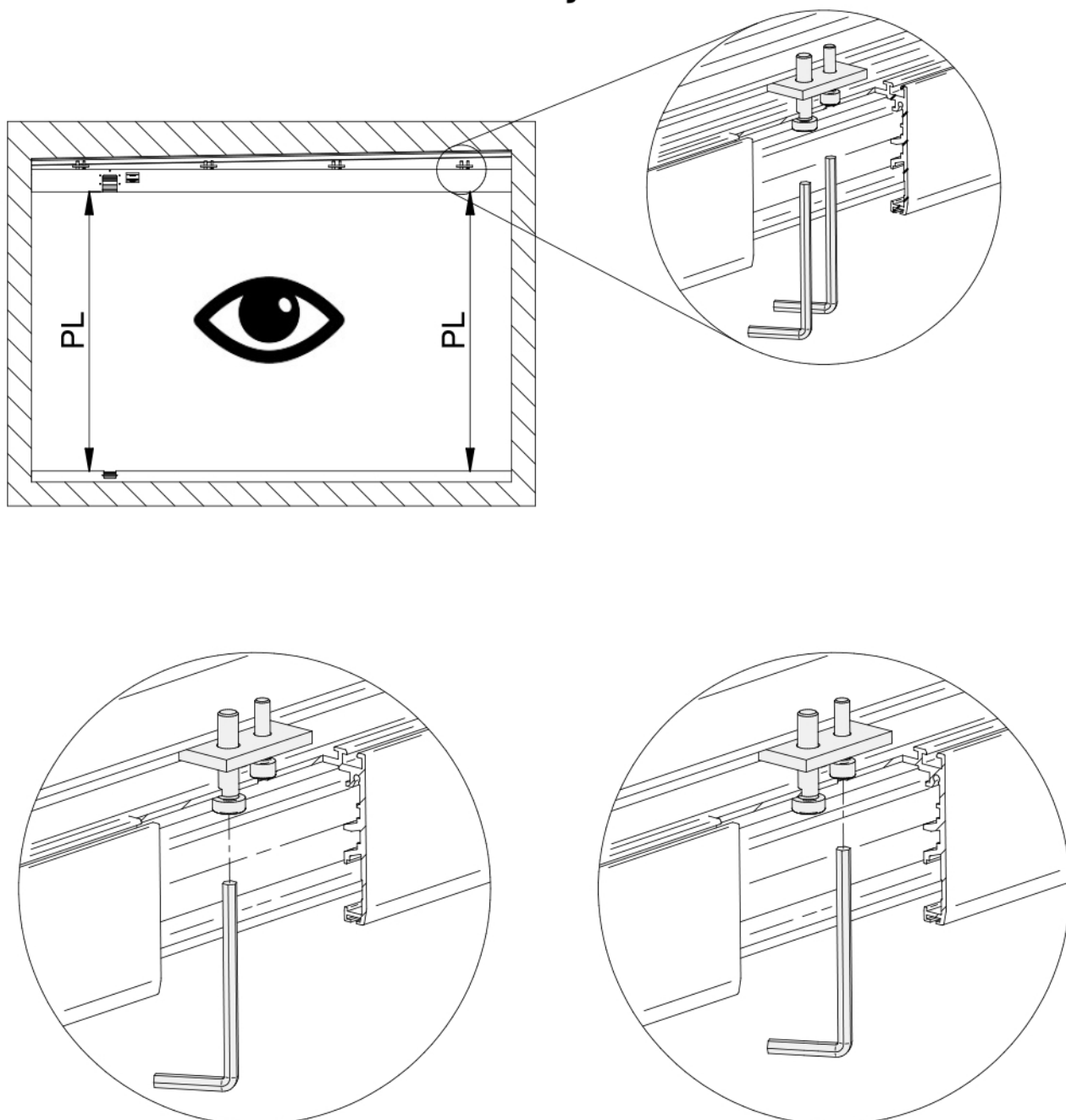

9 Fixing components in the track

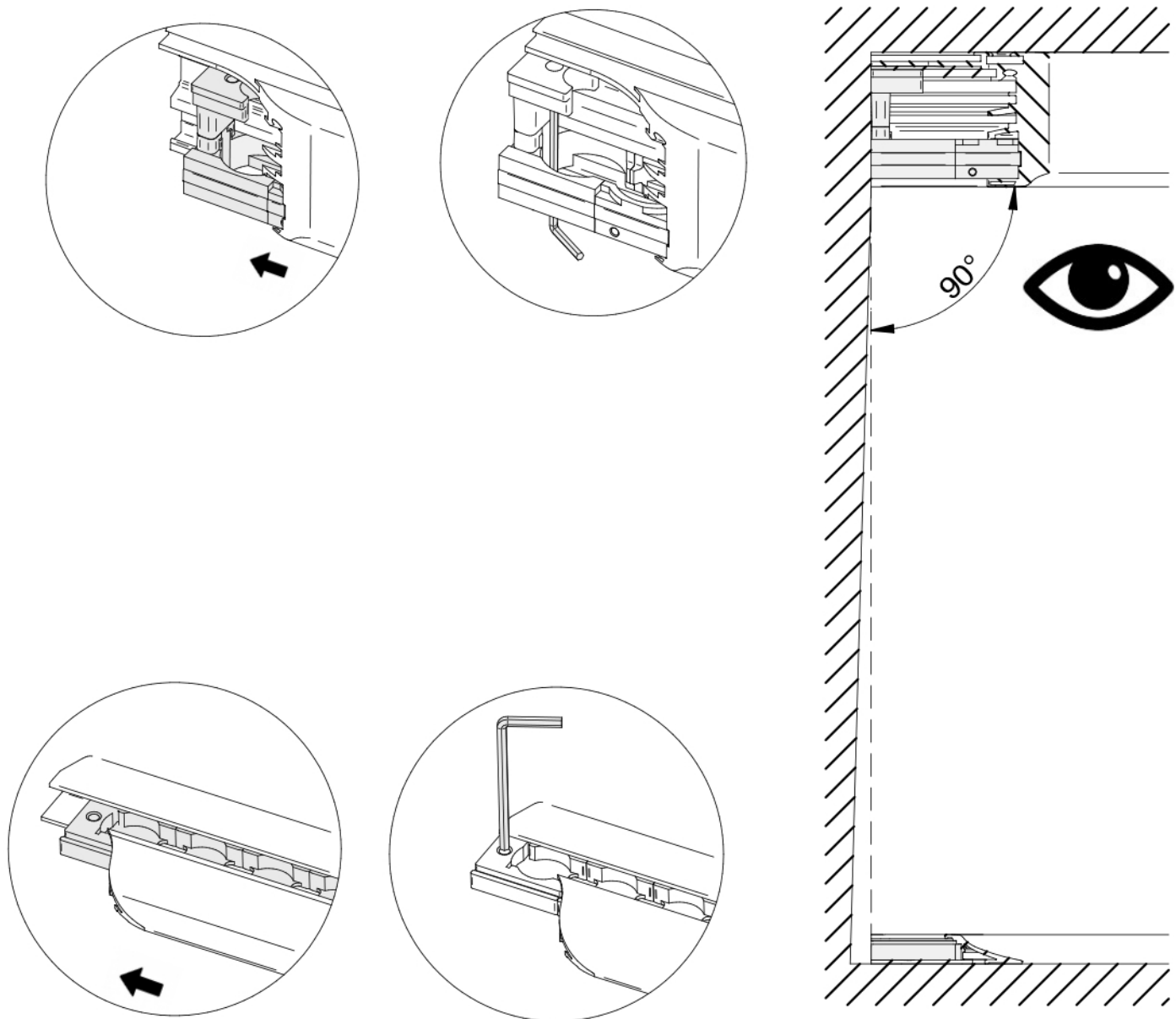

Optional: 8 Mounting vertical profiles

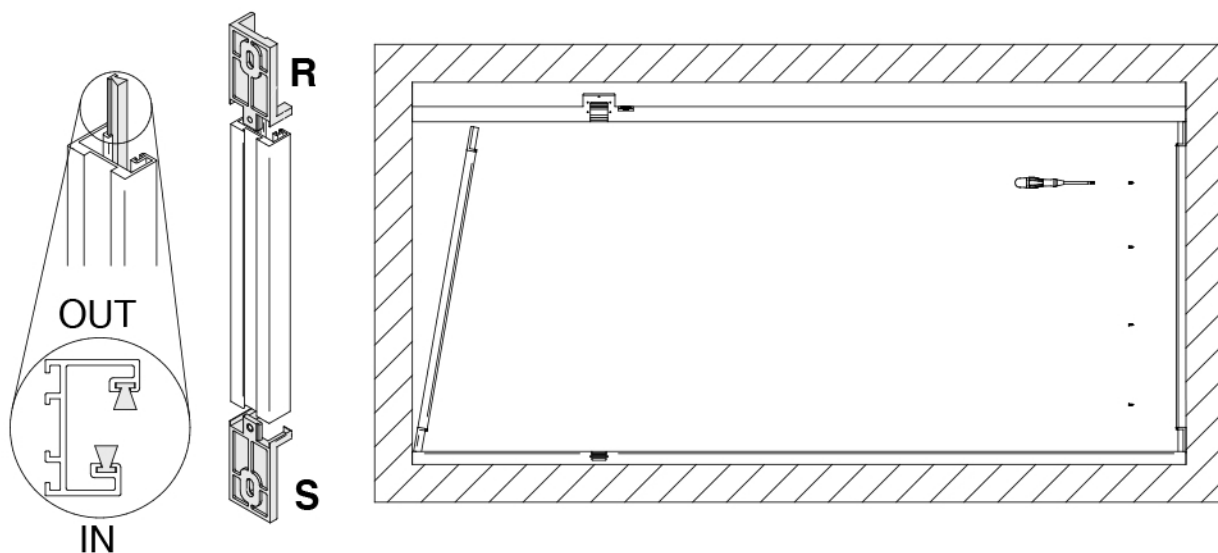

10 Mounting doors

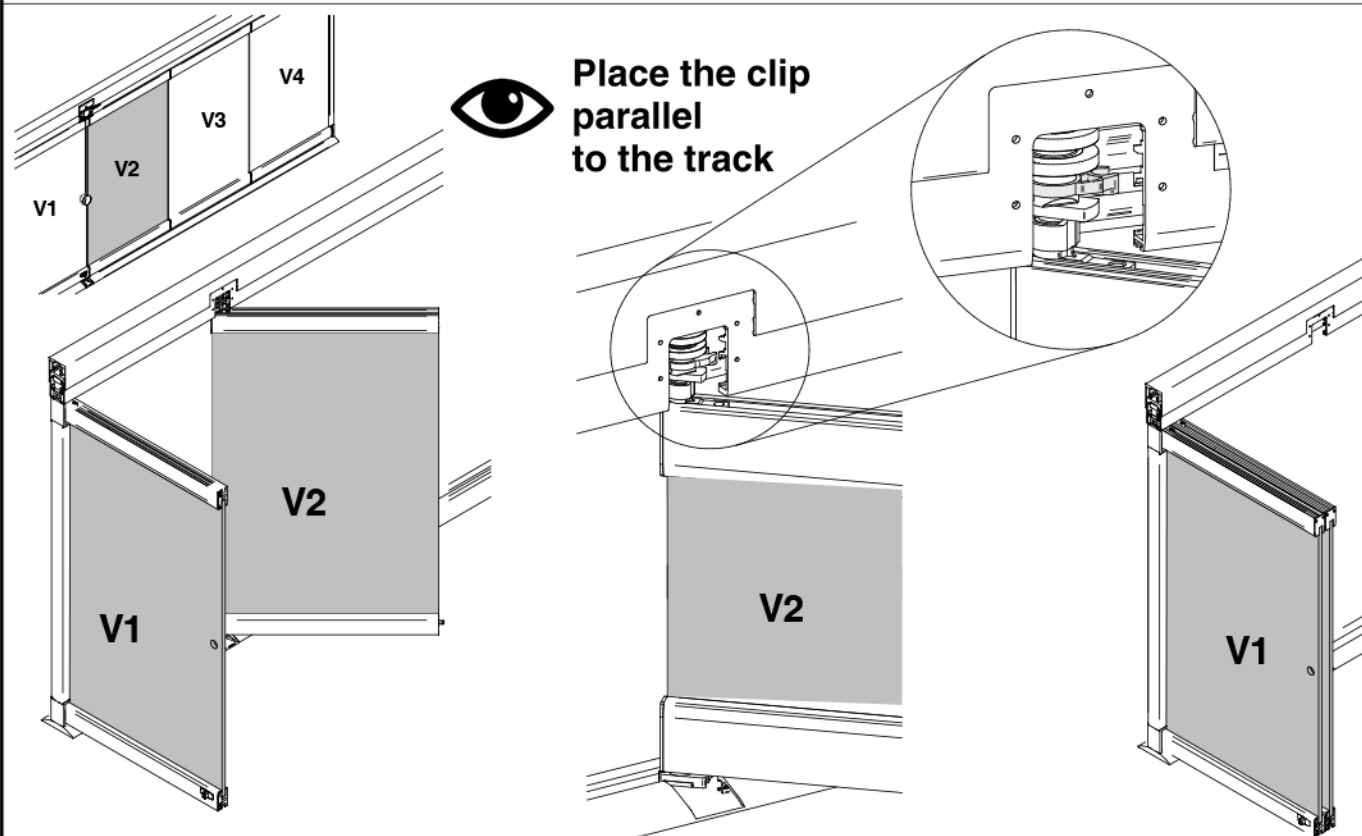
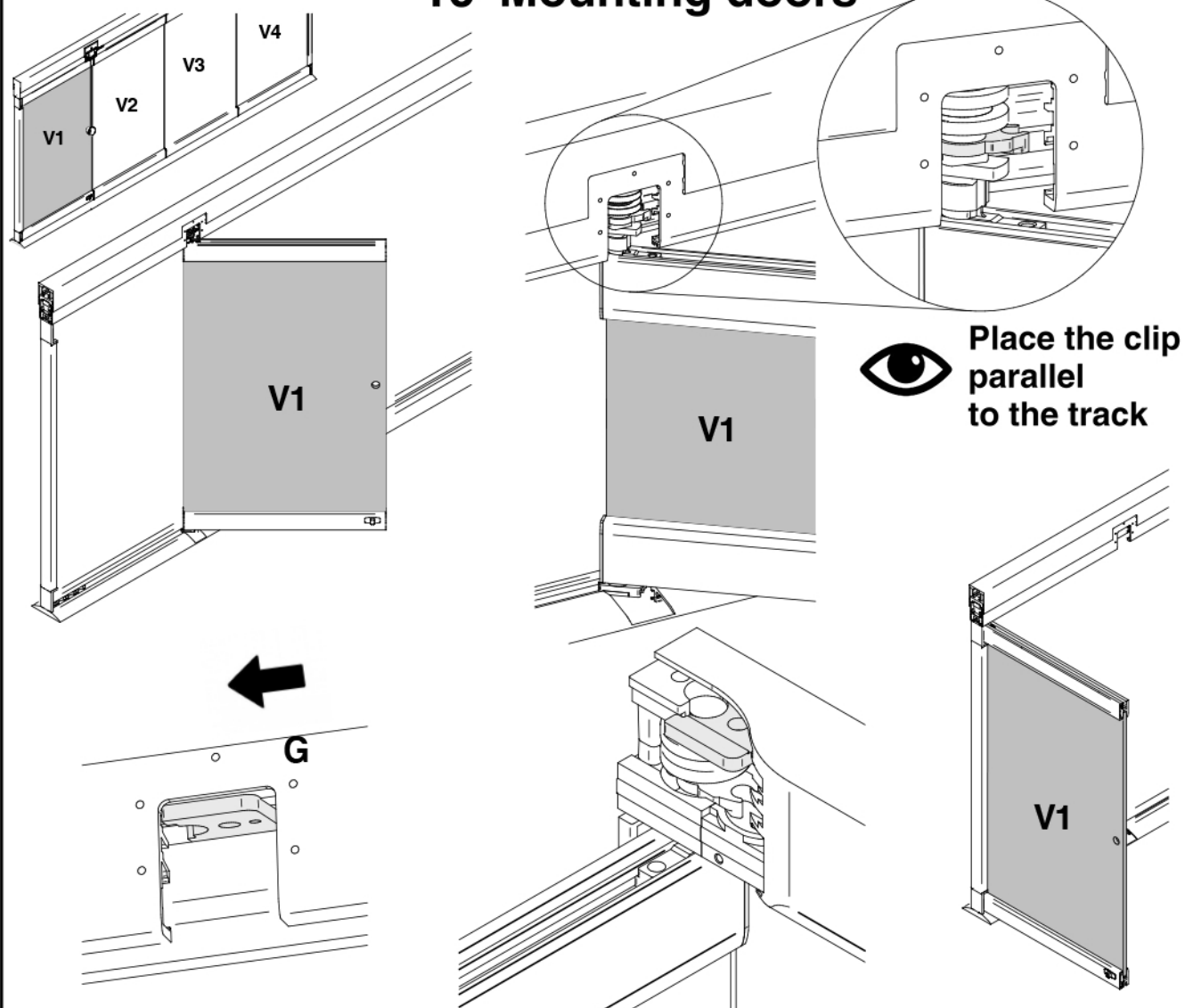

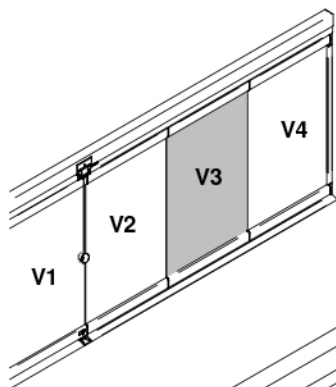

**Place the clip
parallel
to the track**

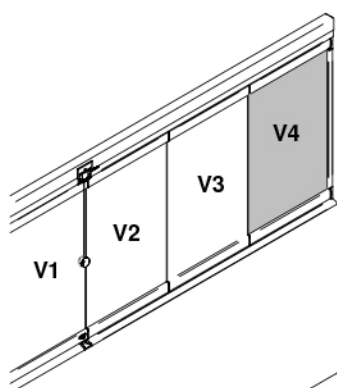
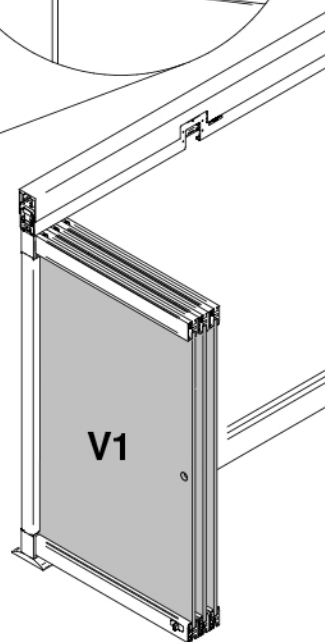
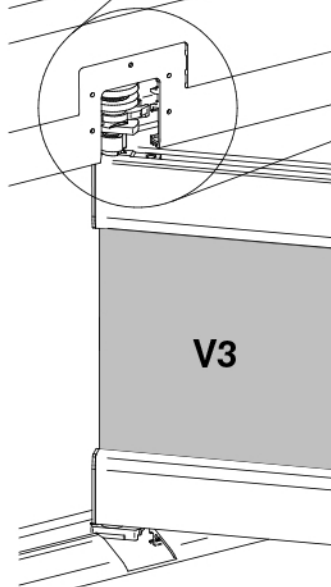
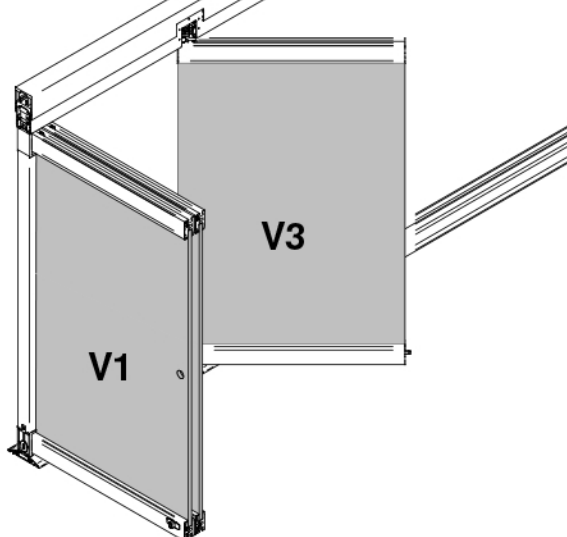
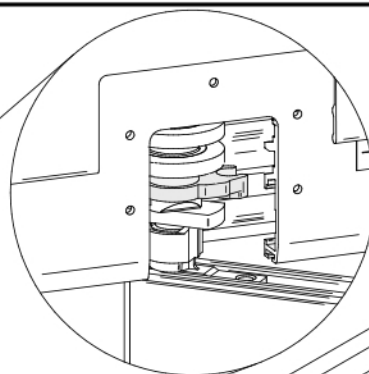

**Place the clip
parallel
to the track**

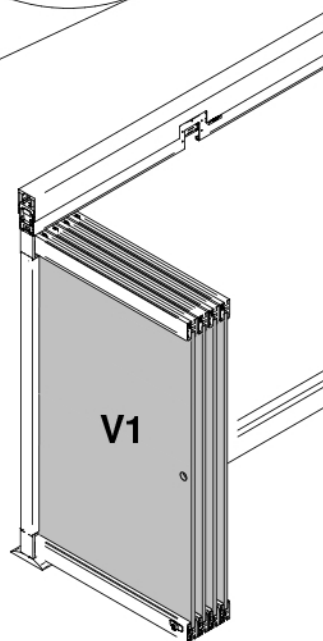
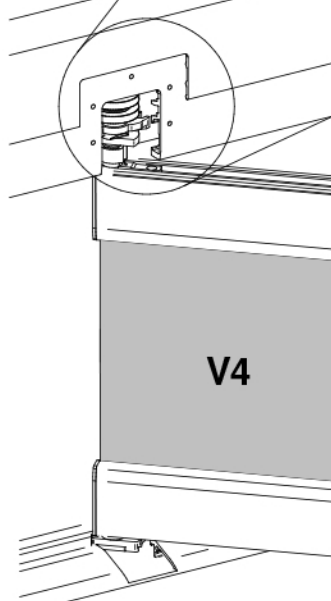
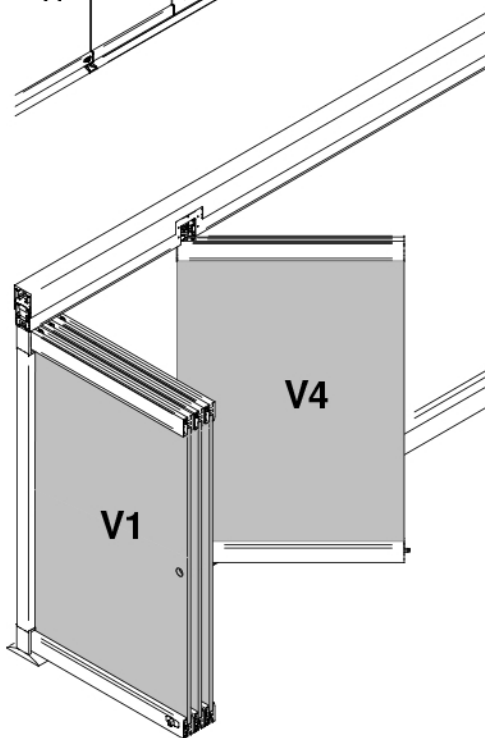
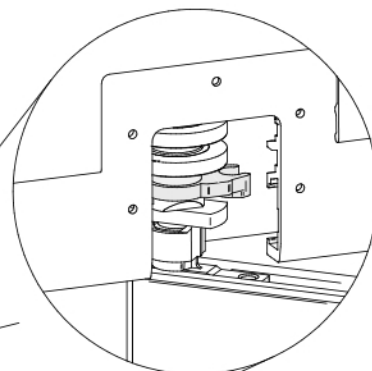

11 Closing procedure

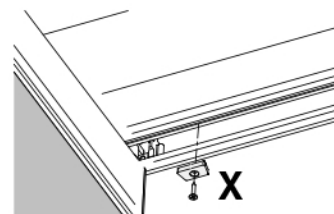
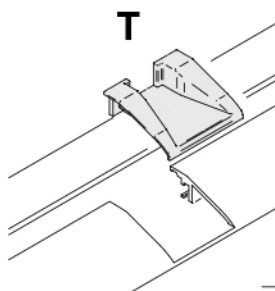
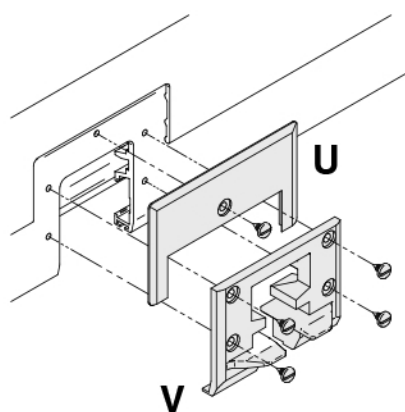

Mount component X
2 pieces every door

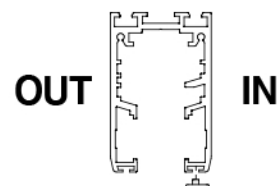
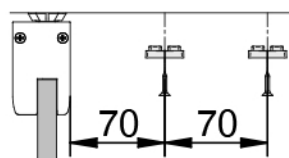

12 Mounting the support trolleys

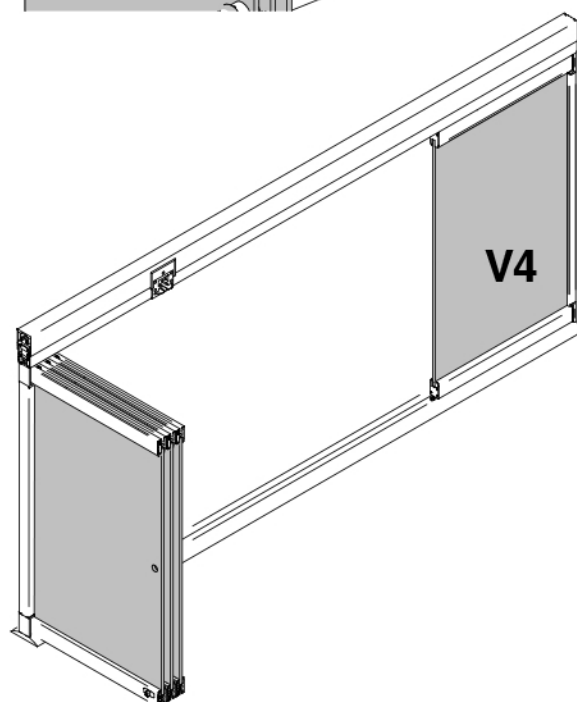
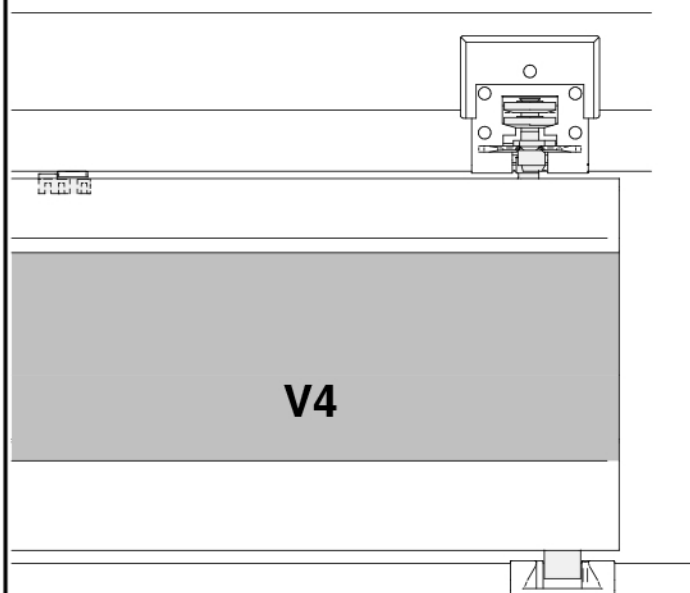
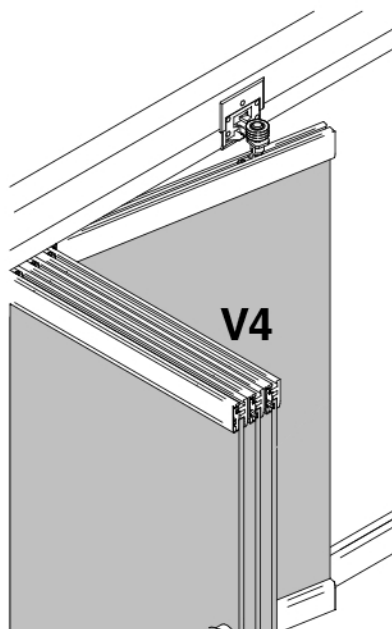
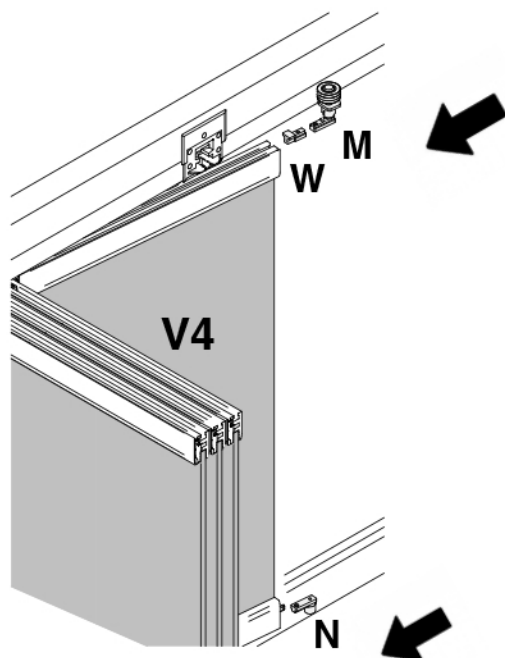

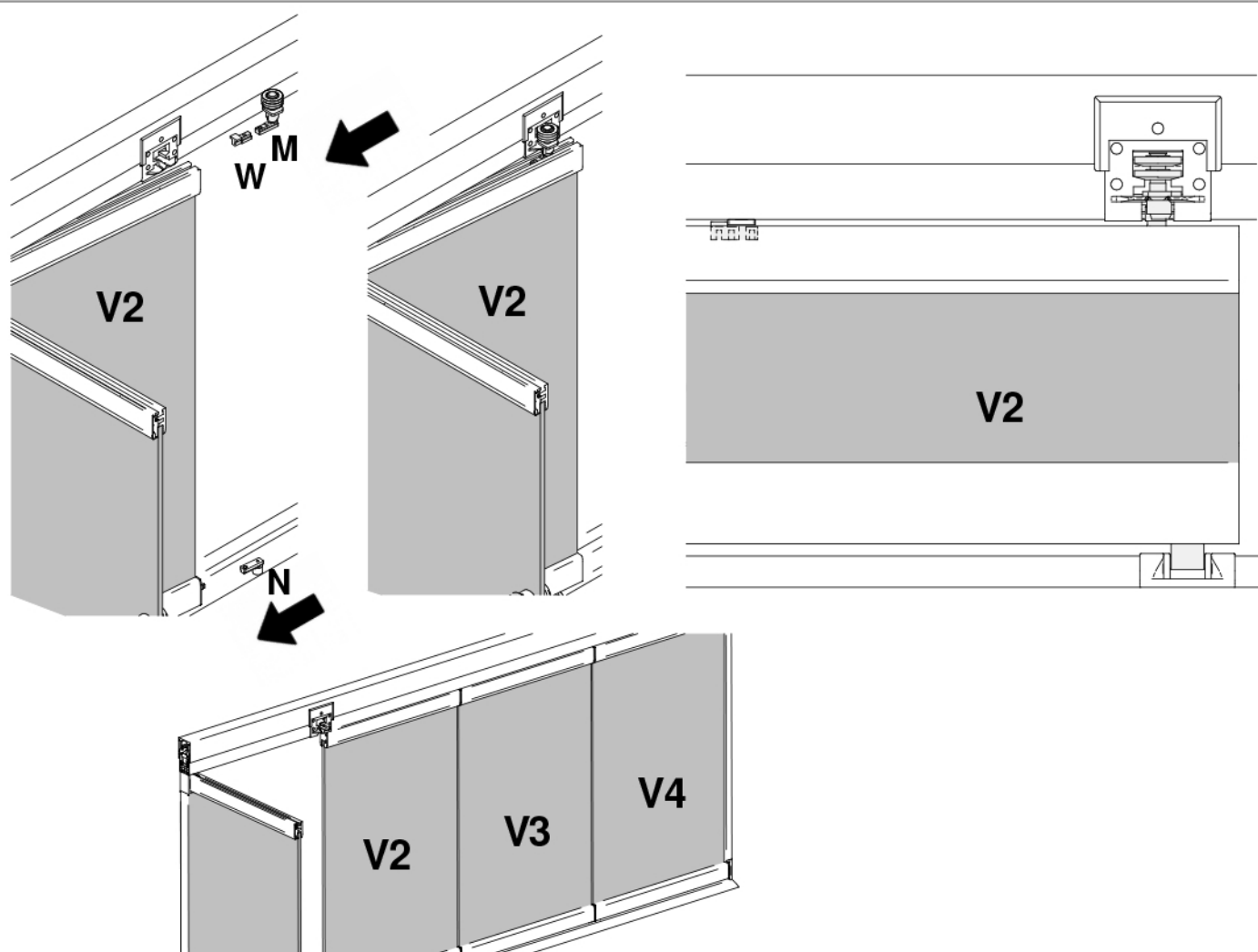
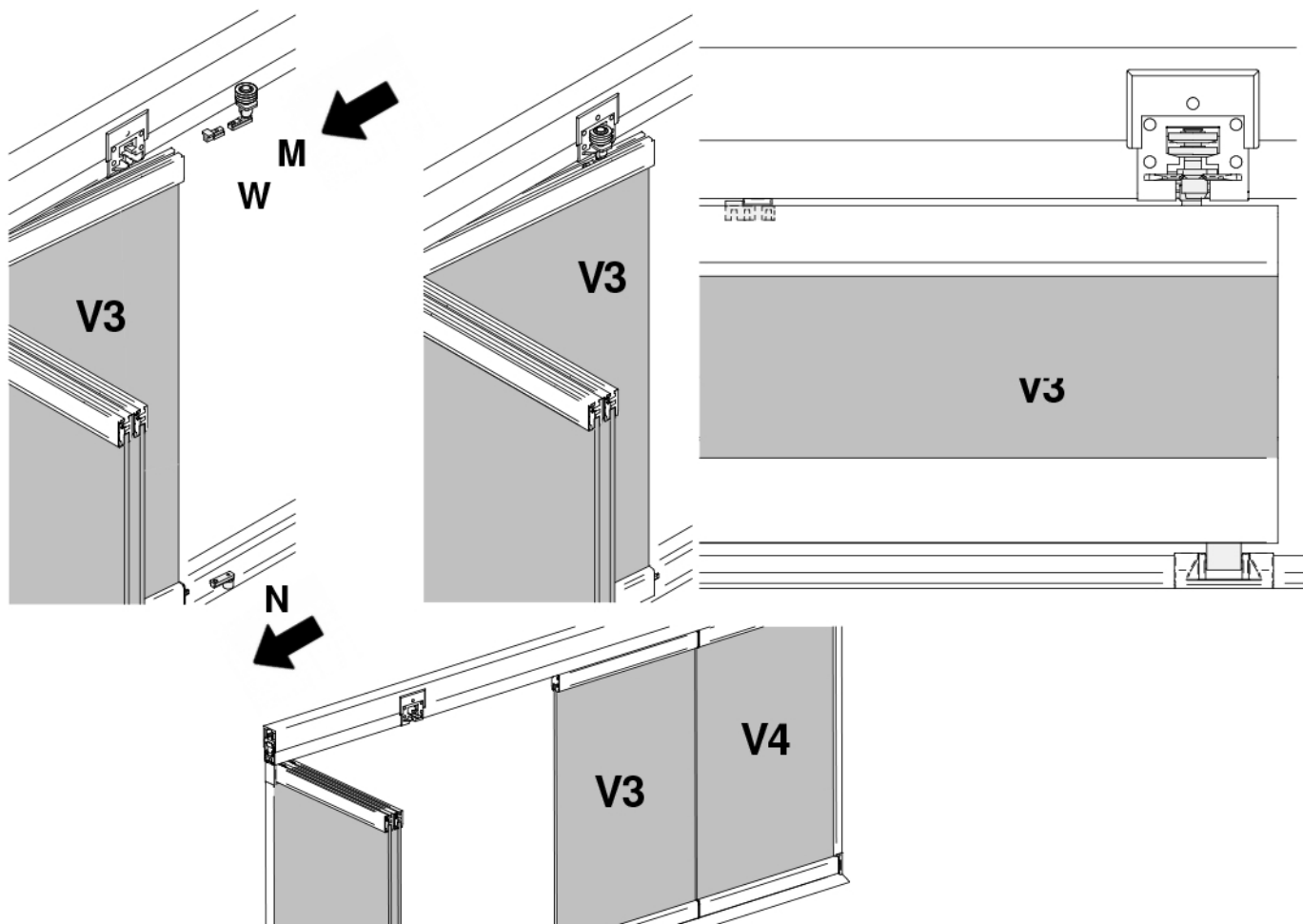

13 Swing door installation

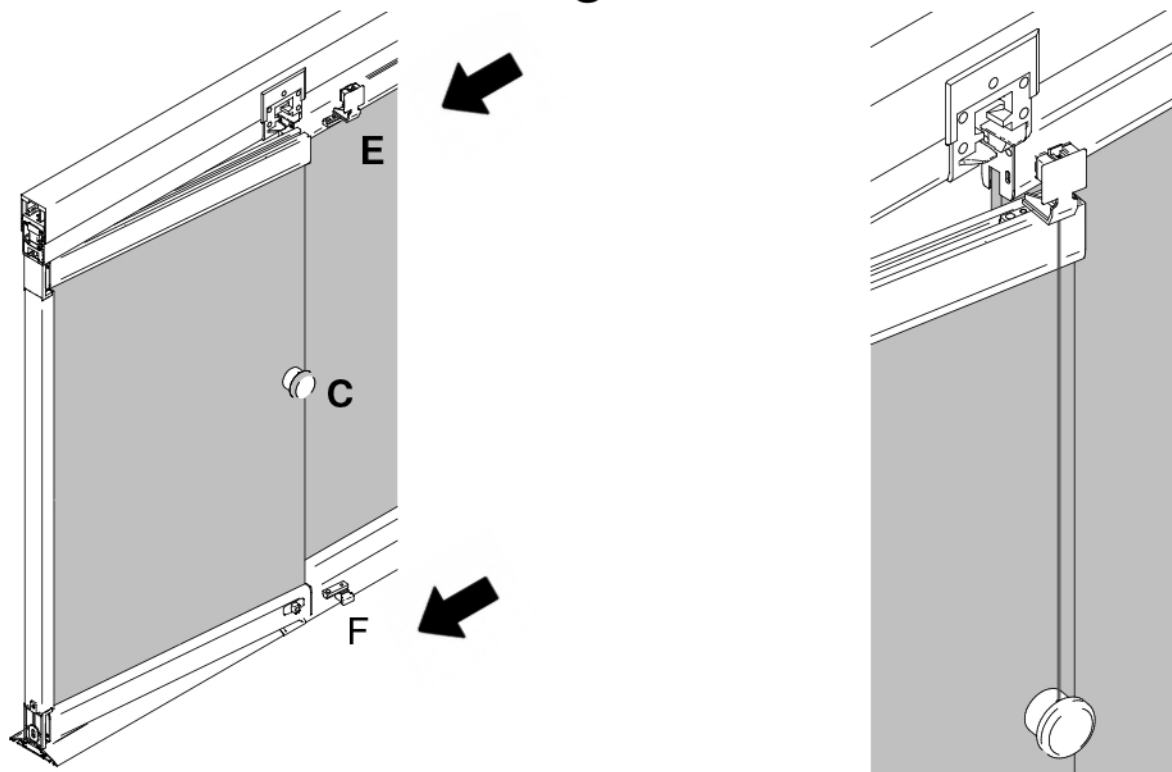

14 Inserting brushes

